



24th Annual ACE of Florida Conference
October 6-8, 2014

WELCOME to the 2104 ACE of Florida Conference

OMNI HOTELS & RESORTS®
championsgate | orlando

Meeting Space At-A-Glance

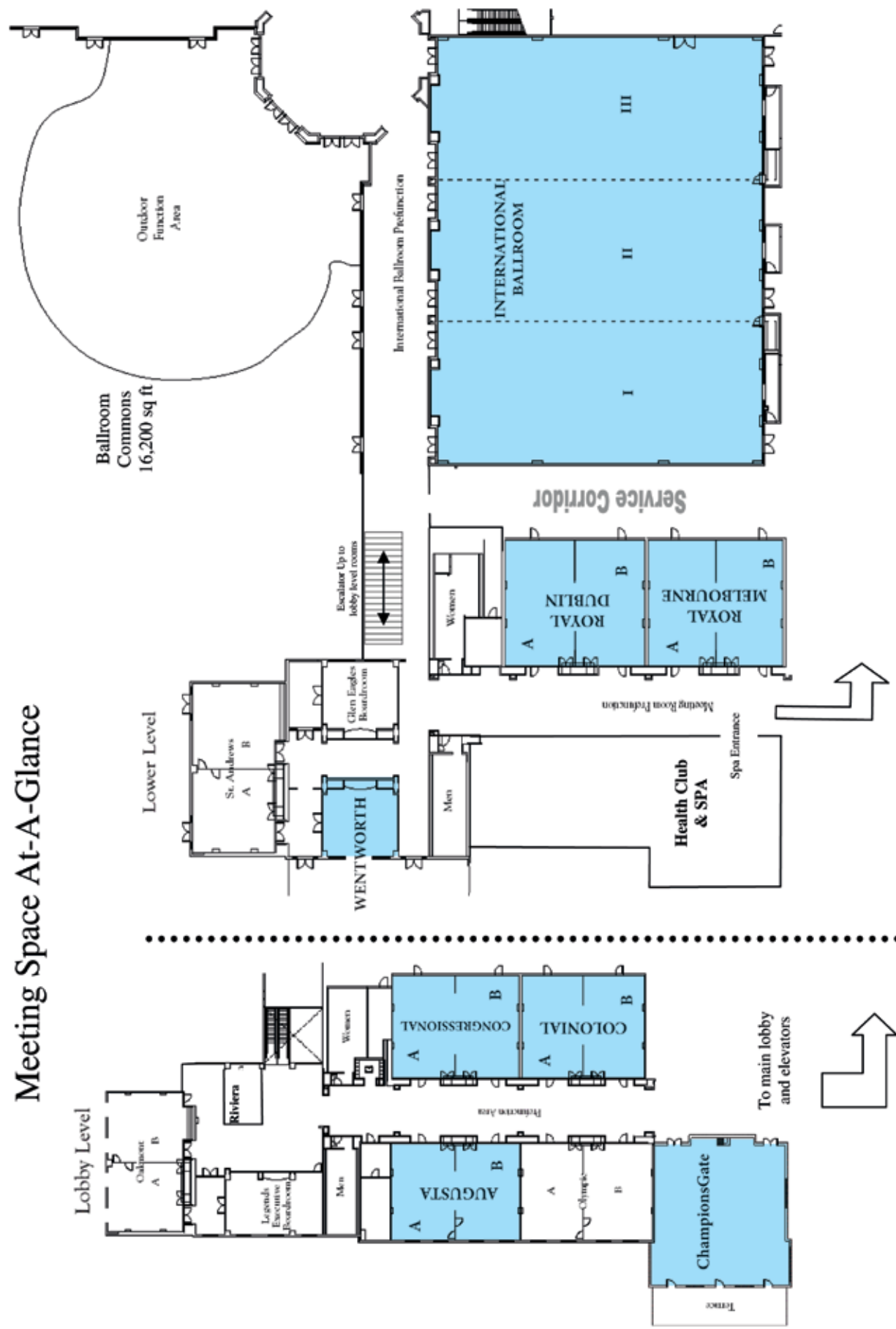



24th Annual ACE of Florida Conference
October 6-8, 2014

TABLE OF CONTENTS

Hotel Map.....	2	24th Annual ACE of Florida Awards Luncheon Agenda	11
Welcome Letters.....	4-5	Nationally Invited Speakers	12-13
For Your Information	6	At-A-Glance Conference Schedule	14-18
Meetings	6	2014 Conference Committee	19
Special Events & After Hours Activities	7	Schedule of Concurrent Sessions	20-29
ACE Executive Board	8	Conference Exhibitors.....	31-33
ACE Staff and FLDOE	8	Conference Sponsors	34
ACE Board of Directors	9		
Grand Opening General Session Agenda	10		

GREETINGS



The definition of empowerment is “the giving of an ability” and as a verb, empower means “to enable or permit.” As adult educators we come together this week under the theme of “Empowering Those We Serve.” Welcome to the ACE of Florida Conference of 2014!

When our students turn to us as that beacon of light in an often dimly lit life, we become that enabler who provides the ability for them to take ownership of their own paths to success! Enabling individuals through adult education becomes the steering current of their futures and the futures of their families, while allowing us as educators to benefit from the intrinsic rewards of bettering those communities around us!

Throughout this conference, ACE of Florida hopes to empower you to become an even better educator so you may in turn empower those you serve each day in your own organizations! As your professional association, ACE of Florida is committed to the promise of supporting each and every adult educator in Florida! Best wishes for a great conference and the most valued school year ever!

Marc Hutek

President, ACE of Florida, Inc.

2014 Conference Chairman

Director, Adult Education, Hillsborough County Public Schools



Rod Duckworth
*Chancellor, Division of Career
and Adult Education, Florida
Department of Education*

Welcome to the 2014 ACE Conference! I am excited to once again be a part of such a great conference and to have the opportunity to meet all of the great teachers, administrators and supporters of adult education who help to empower so many students everyday across the state. This year's conference theme, "Empowering Those We Serve," is especially appropriate because of the career pathways that students can choose, as a result of our great adult education programs.

As we begin a new school year, we must all remember to continue to find ways to support and promote our adult education programs. Much of the work that takes place in adult education never seems to be communicated with the public. In fact, most people know very little about your great work in empowering students by connecting them into career pathways. Whenever I have the opportunity to speak about adult education, I always share that our programs do not end with the passage of an equivalency exam, but begin with a career pathway which will lead to a career and a future. That pathway begins with you as teachers, administrators and supporters of adult education.



Zelda Rogers
*Program Director for
Adult Education, Division of
Career and Adult Education,
Florida Department of
Education*

It is your continued guidance and support of students that make the difference in their lives. We are all here today because someone, whether a teacher, administrator, principal or counselor, made a difference in our lives. So as you continue your work with students, please continue to remember that the ultimate goal of our programs is to empower your students to achieve career success.

Welcome to the ACE Conference. Empowering our adult learners is a major focus of our adult education programs. This year's conference sessions are loaded with strategies to help keep your learners engaged and empowered to make educational choices that lead to success. Take this opportunity to network with your colleagues to learn about and share promising practices happening around the state. Reenergize and enjoy!



Valorie Boyd
*Executive Director,
ACE of Florida and ACE of
Florida Foundation*

The 24th annual ACE of Florida Conference has been planned to empower all of our adult educators, giving them the tools, resources and professional development training to face their day-to-day challenges when they return to the school districts and state colleges. "Empowering Those We Serve" has a two-fold message: 1.) ACE of Florida is working to "empower" the adult education practitioners by keeping them informed, trained and represented. 2.) The adult education teachers will then "empower" their students to achieve and reach their educational goals and beyond.

I welcome you to the 2014 ACE Conference. We have scheduled an exciting and meaningful agenda. Get ready to harness your super powers and reach for the stars. Enjoy the conference.

FOR YOUR INFORMATION

REGISTRATION INFORMATION

The Full Registration Fee Includes:

Intensive Training Sessions, Sunday afternoon
Welcome Reception, Sunday Evening
Exhibit Hall Visitation
Grand Opening General Session, Monday
Concurrent Sessions
Refreshment Breaks
Ice Cream Social and Bingo with the Board, Monday
Luncheon, Tuesday
President's Reception, Dance and Casino Night, Tuesday
ACE Awards Luncheon, Wednesday

NAME BADGES

Name badges are required for entrance to all functions and the Exhibit Hall. Please wear your badge during scheduled conference events.

SPECIAL EVENT TICKETS

In your registration packet, you will receive a perforated sheet that contains your special event tickets. Special Event tickets are not transferable. You must have the ticket and your name badge to be admitted into the following events:

Intensive Training Sessions, Sunday
Welcome Reception
Tuesday's Luncheon
President's Reception, Dance and Casino Night
ACE Awards Luncheon
TAFE On-Line Training, Wednesday

Additional tickets for the luncheons may be purchased for \$45 each at the conference registration desk.

LOST AND FOUND

Please report all articles, lost or found, to the ACE Conference registration desk. At the conclusion of the conference, all unclaimed items will be given to the Omni ChampionsGate Lost and Found Department.

REGISTRATION HOURS

Location: International Ballroom I

Sunday, October 5 1:00 p.m. - 6:00 p.m.
Monday, October 6 7:30 a.m. - 11:45 a.m.
 1:30 p.m. - 4:45 p.m.
Tuesday, October 7 7:30 a.m. - 11:45 a.m.
 1:30 p.m. - 4:30 p.m.
Wednesday, October 8 7:30 a.m. - 11:30 a.m.

EVALUATION FORMS

Please complete the concurrent session and the overall conference evaluation forms. Your feedback is very important to us in planning next year's conference. At the end of each concurrent session, fill out the evaluation form and leave it in the meeting room. You may turn in your overall conference evaluation form at the end of the ACE Awards Luncheon and receive a special gift.

ACCESS STATION

An Access Station for individuals requesting special accommodations is located at the Omni ChampionsGate hotel registration desk.

ACE AWARDS LUNCHEON

The Awards Luncheon will begin promptly at 12:00 p.m. The Awards Luncheon is included in the full conference registration fee. You may purchase additional Awards Luncheon tickets for \$45 each. You must have your ticket to be admitted to the lunch. Tickets are not transferable.

MEETINGS

Sunday, October 5

ACE of Florida Board of Directors' Meeting

Location: Royal Melbourne A
Time: 12:00 p.m. – 2:00 p.m.

Tuesday, October 7

FATDEC General Membership Meeting

Location: Wentworth
Time: 5:00 P.M. – 6:00 P.M.

EXHIBITOR SCHEDULE

Sunday, October 5Exhibitor Set-up..... 2:00 p.m. - 5:00 p.m.

Monday, October 6 Exhibit Hall Hours 8:00 a.m. - 5:00 p.m.

Grand Opening of Exhibits & Continental Breakfast	8:00 a.m. - 8:45 a.m.
Exhibit Visitation	10:45 a.m. - 11:00 a.m.
Exhibitor Visitation & Refreshment Break.....	3:00 p.m. - 3:30 p.m.

Tuesday, October 7Exhibit Hall Hours 8:00 a.m. - 3:30 p.m.

Exhibit Visitation with Coffee and Pastries	8:00 a.m. - 8:30 a.m.
Exhibit Visitation	9:15 a.m. - 9:30 a.m.
Exhibit Visitation	10:45 a.m. - 11:00 a.m.
Exhibit Visitation & Refreshment Break.....	2:45 p.m. - 3:15 p.m.
Exhibit Dismantle.....	3:30 p.m.

Wednesday, October 8.....Exhibit Hall Closed

SPECIAL EVENTS & AFTER HOURS ACTIVITIES

Sunday, October 5

Intensive Training Sessions

Empowering All Adult Education Administrators for College and Career Readiness Standards

Presenters: Zelda Rogers, IPDAE Team, Ila Waite-Burns

Location: Congressional A & B

Time: 2:00 p.m. – 5:00 p.m.

Reading Instruction Workshop for Adult Education

Presenter: Claire Valier

Location: Royal Dublin B

Time: 2:00 p.m. – 4:30 p.m.

Welcome to the Empowerment Zone Reception

Location: ChampionsGate Room (Lobby Level of Hotel)

Time: 7:00 p.m. – 9:00 p.m.

Monday, October 6

Grand Opening of Exhibits and Continental Breakfast

Sponsored by: GED Testing Service

Location: International Ballroom I

Time: 8:00 a.m. – 8:45 a.m.

Grand Opening General Session

Location: International Ballroom II

Time: 9:00 a.m. – 10:45 a.m.

Ice Cream Social and Bingo with the Board

Sponsored by: Edgenuity

Location: International Ballroom III

Time: 5:00 p.m. – 6:30 p.m.

Tuesday, October 7

Special General Session – ACE of Florida's Best Practices Round-Up Roll Out

Location: International Ballroom II

Time: 8:30 a.m. – 9:15 a.m.

Power-Up Luncheon (Bring your ticket)

Sponsored by: CTB/McGraw-Hill and McGraw-Hill Contemporary

Location: International Ballroom III

Time: 12:15 p.m. – 1:15 p.m.

President's Reception, Dance & Casino Night (Bring your ticket)

Sponsored by: Houghton Mifflin Harcourt

Location: International Ballroom I

Time: 7:00 p.m. – 11:00 p.m.

Wednesday, October 8

ACE Awards Luncheon and Raffle (Bring your ticket)

Location: International Ballroom III

Time: 12:00 p.m. – 1:30 p.m.

ACE of Florida Conference Bags

Sponsored by: Burlington English



BREAKTHROUGH

To improved student success

Pearson partners with Florida educators to prepare learners to be successful in college, the workforce, and a 21st century global economy.

Visit www.pearsonhighered.com/college-career-readiness

ALWAYS LEARNING

PEARSON

ACE EXECUTIVE BOARD



Marc Hutek
ACE President and
Conference Chair



Andrew Jenkins
President-Elect



Jack Miller
Treasurer



Mary Barrett
Secretary

ACE STAFF



Valorie Boyd
Executive Director



Leigh Ann Clark
Membership
Coordinator &
Office Manager



Julie Roberts
Conference Assistant
& Grant Coordinator

FLDOE



Rod Duckworth
Chancellor,
Division of Career &
Adult Education



Zelda Rogers
Program Director,
Adult Education,
Division of Career &
Adult Education

ACE BOARD OF DIRECTORS



Susan Winters
District I



Martha Compton
District II



Judy Johnson
District III



Dr. Samantha Ertenberg
District IV



Suzy McDowell
District V



Andrew Jenkins
District VI



Jack Miller
District VII



Marc Hutek
District VIII



Dave Barnes
District IX



John Small
District X



Jeff Arnott
District XI



Mary Barrett
District XII



Sylvia Turner
District XIII



Mavis Pacetti
District XIV



Neeta Rancourt
District XV



Nyce Daniel
District XVI



Maria Miranda
District XVII



Dr. Nilda J. Diaz
Ex-Officio

GRAND OPENING GENERAL SESSION

24th Annual ACE of Florida Conference

“Empowering Those We Serve”

Monday, October 6, 2014 • 9:00 a.m. – 10:45 a.m.

International Ballroom II

Call to Order	Marc Hutek , ACE of Florida President and 2014 Conference Chairman
Presentation of Colors	Celebration High School Air Force Junior ROTC Celebration, Florida Colonel (Ret.) Charles McGuirk , Senior Aerospace Instructor
Pledge of Allegiance.....	Marc Hutek
National Anthem.....	Poinciana High School Eagle Singers , Kissimmee, Florida, Antonio Rodriguez , Choral Director
Welcome and Introduction of Guests	Marc Hutek
Welcome to Osceola County.....	Dr. Michael Akes , Assistant Superintendent for High School Curriculum and Instruction, School District of Osceola County
Greetings from the FLDOE.....	Rod Duckworth , Chancellor, Division of Career and Adult Education, Florida Department of Education
Recognition of Conference Sponsors.....	Valorie Boyd , Executive Director, ACE of Florida, Inc.
Legislative Advocacy Recognition	David Barnes , ACE Legislative Committee Chairman
Introduction of the Keynote Speaker	Andrew Jenkins , ACE of Florida President-Elect
Keynote Address	Coach Ken Carter
Announcements	Marc Hutek
Closing Remarks	Marc Hutek

KEYNOTE SPEAKER

Coach Ken Carter

When famed high school basketball Coach Ken Carter locked his undefeated, state play-off team out of the gym and forced them to hit the books, he sent a powerful message. Ridiculed by his community, Coach Carter drove it home to his players to stop counting on athletic potential as the only ticket out of a tough, inner city life. This eventually led to Paramount making a movie about Coach Carter’s drive to better the lives of his players in 2005. It is entitled, “Coach Carter” and stars award winning actor Samuel L. Jackson.

A successful author and speaker, Coach Carter brings the hard-hitting advice about accountability, integrity, teamwork and leadership to succeed both on and off the basketball court. His latest book entitled, “Yes Ma’am, No Sir” The 12 Essential Steps for Success in Life chronicles his personal experiences in life that shaped him to be the man that he is today. It also hits on key points to assist and show others how to lead more productive and successful lives.

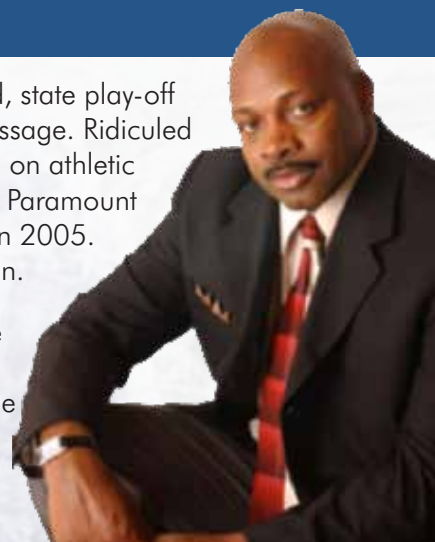

2014 ACE CONFERENCE KEYNOTE SPEAKER

24TH ANNUAL ACE OF FLORIDA AWARDS LUNCHEON AGENDA

“Empowering Those We Serve”

Wednesday, October 8, 2014

12:00 p.m. – 1:30 p.m.

International Ballroom III

Conference attendees please go directly to a table and be seated.

Event	Presenter
Welcome	Marc Hutek , President and Conference Chairman, ACE of Florida
Lunch is served	
Presentation of the Anita Ryall Excellence in Adult and Technical Virtual Education Award	Presented by: Joan Luebbe , President, FATDEC Kimberly Gates , FATDEC Consortium Coordinator
ACE of Florida Outgoing Board of Directors Presentation	Presented by: Valorie Boyd , Executive Director, ACE of Florida
Presentation of the President’s Award	Presented by: Marc Hutek , President, ACE of Florida
Presentation of the 2014 ACE Achievement Awards Legislators of the Year Volunteer of the Year Media Promotion of the Year Non-Instructional Support Staff of the Year Teacher of the Year Administrator of the Year	Presented by: Neeta Rancourt , Awards Chairman Marc Hutek , President, ACE of Florida Rod Duckworth , Chancellor, Division of Career and Adult Education, FLDOE Zelda Rogers , Program Director, Division of Career and Adult Education, FLDOE Andrew Jenkins , President-Elect, ACE of Florida
24th Annual ACE Conference Gift Basket Raffle	Judy Johnson and Jack Miller , Co-Chairmen Raffle Committee, Dave Barnes , Martha Compton , Andrew Jenkins
Closing Remarks	Marc Hutek

Please remember to fill out the Overall Conference Evaluation.
Give it to an ACE Volunteer as you leave the Luncheon and receive a gift.

Thank you for attending this year’s conference. Stay Calm & Be Empowered.

NATIONALLY INVITED SPEAKERS



JAYME ADELSON-GOLDSTEIN

Jayme Adelson-Goldstein is an ESOL teacher educator, curriculum consultant, and author. She facilitates ESOL workshops across the U.S. as well as internationally and teaches ESOL methodology for TESOL and the California Adult Literacy Professional Development Project (CALPRO). She has worked with ACE of Florida and Florida TechNet on several EL Civics projects in the past and is embarking on a new EL CIVICS project this Fall.



DAPHNE ATKINSON

Daphne Atkinson is currently Senior Director, State Relationships, at GED Testing Service, a joint venture of the American Council on Education (ACE) and Pearson. Ms. Atkinson has spent seventeen years in the education industry—four years with GED Testing Service as well as more than nine years at the Graduate Management Admission Council® (GMAC®), where she

served as Vice President, Industry Relations. Prior to GMAC® she held the position of Assistant Dean of Admissions at Cornell's Johnson Graduate School of Management directing MBA recruitment, admissions, and overseeing scholarship programs. Ms. Atkinson also spent several years as a financial manager with Dun & Bradstreet and with the U.S. General Accounting Office (now the Government Accountability Office).



ADRIENNE BARNES

Adrienne Barnes is a doctoral fellow with the Florida Center for Reading Research (Florida State University). She has fifteen years of experience instructing children and adults of all ages and levels, with a focus on literacy instruction. She is currently working as a trainer and curriculum consultant with RTI International and the Ethiopian

Ministry of Education on the USAID/READ-TA grant to provide in-country training and improve teacher education programs in Ethiopia.



MICHAEL BRUSTEIN

Michael Brustein has been a leading expert on federal education grants management and workforce legislation for 40 years. He is a private attorney in a Washington, D.C. firm that maintains a nationwide practice, and represents various State and local agencies, post-secondary institutions, and workforce boards on federal compliance issues before the federal agencies.

His firm has served as counsel to the Florida Department of Education since 1981. Mr. Brustein also serves as counsel to an array of national educational organizations with a focus on both fiscal and programmatic compliance issues. His firm maintains a federal legislative practice for several states, local districts, and postsecondary agencies by which the firm keeps these agencies abreast of legislative, regulatory, and judicial developments in Washington, D.C. Since entering private practice in 1980, he has worked with legislative staff in the drafting of several major education and workforce bills, including the Adult Education Act. He has authored or co-authored an assortment of texts and manuals on federal legislation, including the "Administrator's Guide to the Adult Education and Family Literacy Act of 1998." With the enactment of the WIOA in July 2014, the firm has just released "The Administrator's and Provider's Guide to the Adult Education and Family Literacy Act of 2014."



MARSHA CHAN

Marsha Chan, BA, MA, Stanford University, enjoys engaging participants in pedagogical discussions about adult language learning. Winner of numerous excellence awards, including Teaching Excellence and Publication & Presentation Excellence, she facilitates workshops in the U.S. and abroad. She makes generous use of relevant multimedia technology and devices to enhance

interaction and development in spoken and written forms. ACE conference goers are invited to make use of her free instructional videos at <http://www.youtube.com/PronunciationDoctor>. If you like a video, sign in and LIKE it!



CHRIS HART IV

Chris Hart IV is President/CEO of CareerSource Florida. Chris is a two-term member of the Florida House of Representatives, and has a long history of service to the state in workforce and economic development roles including Interim Director of the Governor's Office of Tourism, Trade and Economic Development (OTTED), Chairman of the Governor's Gulf Oil Spill Economic Recovery

Task Force, Chairman of the state's Employer-Sponsored Benefits Study Task Force and Senior Vice President of External Affairs and Investor Relations for Enterprise Florida Inc.



MEGHAN HAUPTLI

Meghan is the Professional Development Coordinator for CPALMS (www.cpalms.org). In this capacity, she coordinates a statewide network of Regional Coordinators and designs and facilitates statewide professional development initiatives related to standards-driven instruction, lesson plan development, and the review of educational resources. Before moving to

Tallahassee, Meghan was a teacher in Miami-Dade County.



DR. JOHN HOSTERMAN

John Hosterman, Ph.D. is the Director of Global Accessibility at Pearson VUE. His responsibilities include oversight of the department responsible for reviewing all disability-related accommodations requests for the GED Testing Service and many other Pearson VUE clients, as well as guidance regarding disability policy and accessibility.

Prior to this, Dr. Hosterman was the Director of Accommodations Review for the Medical College Admissions Test (MCAT). He is the editor-in-chief and a primary author of the recent publication, *Medical Students with Disabilities: Resources to Enhance Accessibility* (Association of American Medical Colleges, 2010).



LORI HOWARD

Lori Howard is an ESL consultant, teacher educator, author of reading textbooks for adult ESL learners and frequent presenter at state and international conferences. She is also AEFLA/WIA II Program Specialist Coordinator for CASAS. Her 38 years of experience in the field includes teaching ESL, administering ESL programs and being a TV/Video teacher on the Los Angeles

Unified School Districts' Learning English Series. She holds a TESL Certificate from UCLA and a Masters Degree in Educational Administration from Pepperdine University.



BROOKE ISTAS

Ms. Brooke Istas is currently a Professor of Mathematics for Cowley College. Prior to accepting the position as math faculty, she acted as the Instructional Coordinator for the Cowley College Adult Education program and was an online Mathematics Instructor for developmental education and credit-bearing courses. She has served as the U.S. Department of Education, Office of Vocational and Adult Education (OVAE), Department of Adult Education and Literacy's LINCS Community of Practice Math and Numeracy Group Leader and Subject Matter Expert. Also for the LINCS Regional Professional Development Centers, she is certified as a National Trainer in math and numeracy and serves as a Subject Matter Expert Reviewer vetting math and science resources for the LINCS online Resource Collection.



JOE MCVEIGH

Joe McVeigh has been in the field of ESL for (gasp!) more than 30 years. For much of his career he worked as a teacher and administrator in intensive English programs in southern California. These days he is based in Middlebury, Vermont where he writes, gives professional development workshops and consults with organizations on various aspects of English language teaching. Joe is a co-author (with Jenny Bixby) of two books in the Q: Skills for Success series from Oxford and a co-author of Tips for Teaching Culture, a teacher-training book from Pearson. He's also written works for hire for companies including Cengage-National Geographic. As a development editor he has worked on more than 10 projects for Cambridge and for McGraw-Hill. He's also worked on digital projects for DynEd, Global English, and Macmillan.



JOHN D. MEYER, PHD, EDS

Dr. John Meyer is an Associate Director of Instructional Technology at the Florida Institute of Technology (FIT). He holds a doctorate and an Education Specialist degree in Computing Technology in Education from NOVA Southeastern University. He plans, and directs the implementation of educational technology for campus classrooms and online interactive educational environments. He also teaches graduate education technology students how to implement the latest educational technology.



MARGARET BECKER PATTERSON, PHD

Dr. Patterson is an experienced adult education researcher, has administered and taught in adult education programs in Nebraska, Nevada, and Kansas, and has presented extensively across the USA. A former state associate director of adult education, she has also worked in research positions at university and state levels. She served as director of research at GED Testing Service from 2008 to 2011. She is currently Senior Researcher with Research Allies for Lifelong Learning (www.researchallies.org) and partners with non-profit organizations, postsecondary institutions, and state agencies in that role. She also serves on the board of the National Coalition for Literacy.



STEVE QUANN

Steve Quann's dual interests in technology and teaching English language learners led to his co-authoring two books on technology integration into instruction. Steve is Senior Advisor for Technology in Education for World Education, works as an instructional technologist and national trainer for LINCS. He leads e-learning and mobile learning projects and facilitates EdTech workshops both national and internationally.



ROBERTA REISS

Roberta is a Certified National Trainer for Learning to Achieve. Her Literacy Program serves adult new readers and English learners. She has trained volunteer tutors for community-based literacy programs throughout the country. A ProLiteracy Certified Tutor Trainer for 14 years, she mentors others in achieving their own certification. She has presented at many conferences including Miami Elite, ProLiteracy Worldwide, USAL, COABE, ALA, FLA and Florida Literacy. She facilitates state-wide trainings for the Florida Literacy Coalition. She has served as chairperson for READ Southwest Florida, Region IV Training Council, and SWFLN Continuing Education Committee.



ROGER C. ROSENTHAL

Roger C. Rosenthal, an attorney, is the Executive Director of the Migrant Legal Action Program (MLAP) in Washington, D.C. MLAP is a national non-profit, non-governmental support and advocacy center which provides a voice to migrant and seasonal farmworkers and their families, and immigrants and their families, regarding education, civil rights, food and nutrition issues, immigration policy, and other issues.

Mr. Rosenthal is widely recognized as one of the foremost legal experts in the country regarding the rights of immigrant children and English Language Learners in the public schools. He also has considerable expertise with respect to U. S. immigration policy.



RACHEL UNRUH

Rachel helps lead National Skills Coalition, which works to advance policies at the state and federal level that ensure every worker and every industry has the skills to compete and prosper. She has 15 years of experience in workforce development, higher education and adult basic education policy and has authored numerous reports about policies that can help ensure that individuals with low basic skills obtain credentials with labor market value. Rachel joined NSC in 2006 to develop and lead Skills2Compete, a national campaign replicated in 13 states that brought the nation's middle-skill gap to the attention of the American public and policymakers.



CLAIRE VALIER

Claire Valier is an ESOL professional who has served on the State of Florida's ESOL Task Force and Standing Committee before she retired, and is a well-known presenter for the State of Florida as well as providing staff training in numerous other states. She is a certified National CASAS Trainer and a certified National Reading Horizons Consultant.

AT-A-GLANCE

Sunday, October 5

Session Time	Presentation Title	Lead Presenter	Room
12:00 p.m. - 2:00 p.m.	ACE of Florida Board of Directors Meeting	Marc Hutek, President	Royal Melbourne A
1:00 p.m. - 6:00 p.m.	Registration		International I
2:00 p.m. - 5:00 p.m.	Exhibitor Setup		International I
2:00 p.m. - 5:00 p.m.	Empowering All Adult Education Administrators for College and Career Readiness Standards	Zelda Rogers	Congressional A and B
2:00 p.m. - 4:30 p.m.	Reading Instruction Workshop for Adult Education	Claire Valier	Royal Dublin B
5:00 p.m. - 7:00 p.m.	Dinner on your own		
7:00 p.m. - 9:00 p.m.	Welcome to the Empowerment Zone Reception		ChampionsGate Room (Lobby Level)

Monday, October 6

7:30 a.m. - 11:45 a.m. 1:30 p.m. - 4:45 p.m.	Registration		International I
8:00 a.m. - 5:00 p.m.	Exhibit Hall Open		International I
8:00 a.m. - 8:45 p.m.	Grand Opening of Exhibit Hall - with Continental Breakfast Sponsored by GED Testing Service		International I
9:00 a.m. - 10:45 a.m.	Grand Opening General Session		International II
10:45 a.m. - 11:00 a.m.	Visit with the Exhibitors		International I

Concurrent Sessions I

11:00 a.m. - 12:15 p.m.	TABE Update	Jane Silveria	Augusta A
11:00 a.m. - 12:15 p.m.	Transitioning Adult Learners and Non-Learners: US Findings from PIAAC	Margaret Patterson	Augusta B
11:00 a.m. - 12:15 p.m.	Best Practices for Adult Learners to Catch Up, Keep Up, and Get Ahead by Using Digital Content - (EXHIBITOR)	Blythe Adreon	Colonial A
11:00 a.m. - 12:15 p.m.	Working Towards Student Success with Career Pathways	Roxana Hurtado	Colonial B
11:00 a.m. - 12:15 p.m.	Taking Care of Yourself: Making the Transition from Corrections to Work, Education, and Daily Life	Anne Meisenzahl	Congressional A
11:00 a.m. - 12:15 p.m.	CASAS Update	Linda Taylor	Congressional B
11:00 a.m. - 12:15 p.m.	www.floridaipdae.org	IPDAE Team	Royal Dublin A (Computer Lab)
11:00 a.m. - 12:15 p.m.	Success of an Online, Learner Centered GED Prep Program (EXHIBITOR)	Cindy Hewitt	Royal Dublin B
11:00 a.m. - 12:15 p.m.	Civics in the ESL and GED Classrooms	Chad Bryant	Royal Melbourne A
11:00 a.m. - 12:15 p.m.	Accommodations on High Stakes Tests (Repeat Session)	John Hosterman	Royal Melbourne B
11:00 a.m. - 12:15 p.m.	English Discoveries Online - The Next-Generation Interactive Solution for English Language Learning (EXHIBITOR)	Jill Rosolek	Wentworth
12:15 p.m. - 1:30 p.m.	Lunch on your own		

Concurrent Sessions II

1:45 p.m. - 3:00 p.m.	Mathematical Reasoning: Bringing Math to Life in Your Classroom	Daphne Atkinson	Augusta A
1:45 p.m. - 3:00 p.m.	Integrating Career Awareness into Adult Basic Education & ESOL Classes	Wendy Oliver	Augusta B

Monday, October 6

Session Time	Presentation Title	Lead Presenter	Room
1:45 p.m. - 3:00 p.m.	Online Vocabulary Quizzes and Vocabulary Profiling Tools	Marsha Chan	Colonial A
1:45 p.m. - 3:00 p.m.	Approaching Your Multilevel ESOL Class	Dawn Adolfson	Colonial B
1:45 p.m. - 3:00 p.m.	FSCJ Career Pathways Program	Deana Waite	Congressional A
1:45 p.m. - 3:00 p.m.	Creating e-Learning Strategies that Serve Adult Education Learners - (EXHIBITOR)	Cindi Celske	Congressional B
1:45 p.m. - 3:00 p.m.	The OMB Omni Circular: What You Need to Know to Administer a Federal Grant (Part 1)	Michael Brustein	International II
1:45 p.m. - 3:00 p.m.	CPALMS Overview	Meghan Hauptli	Royal Dublin A
1:45 p.m. - 3:00 p.m.	What If Your Students Aren't GED Ready Yet? (EXHIBITOR)	Deanna Crosson	Royal Dublin B
1:45 p.m. - 3:00 p.m.	BurlingtonEnglish Practice for CASAS—Helping students, teachers, and schools gain LCPs (EXHIBITOR)	Lori Wedner	Royal Melbourne A
3:00 p.m. - 3:30 p.m.	Exhibitor Break and Refreshments		International I

Concurrent Sessions III

3:30 p.m. - 4:45 p.m.	Beyond Career Planning 101	Ila Waite-Burns	Augusta A
3:30 p.m. - 4:45 p.m.	The College and Career Readiness Standards - What Do They Mean for Adult ESOL Teachers?	Philip Anderson	Augusta B
3:30 p.m. - 4:45 p.m.	High Tech, Low Tech, No Tech Solutions	Jane Kim	Colonial A
3:30 p.m. - 4:45 p.m.	GED® 2014: Florida and National Program Trends	Tara Goodman	Colonial B
3:30 p.m. - 4:45 p.m.	Career Pathways: Orientation and the Small District	Melanie Stefanowicz	Congressional A
3:30 p.m. - 4:45 p.m.	Teaching Verb Tense and Voice to Adult English Language Learners	Sergei Paromchik	Congressional B
3:30 p.m. - 4:45 p.m.	The OMB Omni Circular: What You Need to Know to Administer a Federal Grant (Part 2)	Michael Brustein	International II
3:30 p.m. - 4:45 p.m.	Sensible Soft Skills	Anna Schubarth	Royal Dublin A (Computer Lab)
3:30 p.m. - 4:45 p.m.	U.S. Immigration Policy, School Enrollment Issues for Immigrant Students, and Requirements for English Language Learners in Public Schools: What Adult Educators Should Know (Repeat Session)	Roger Rosenthal	Royal Dublin B
3:30 p.m. - 4:45 p.m.	How to Use Social Media to Promote Your Programs	Jeff Arnott	Royal Melbourne A
3:30 p.m. - 4:45 p.m.	Accommodations on High Stakes Tests (Repeat Session)	John Hosterman	Royal Melbourne B
3:30 p.m. - 4:45 p.m.	TABE Meeting	Jane Silveria	Wentworth
5:00 p.m. - 6:30 p.m.	Ice Cream Social and Bingo with the ACE Board Sponsored by Edgenuity		International III
6:30 p.m.	Dinner on your own		

Tuesday, October 7

7:30 a.m. - 12:15 p.m. 1:15 p.m. - 4:30 p.m.	Registration		International I
8:00 a.m. - 3:30 p.m.	Exhibit Hall Hours		International I
8:00 a.m. - 8:30 a.m.	Exhibit Hall Visitation with Coffee and Pastries		International I
8:30 a.m. - 9:15 a.m.	General Session - ACE of Florida's Best Practices Round-Up Roll-Out	Marc Hutek	International II
9:15 a.m. - 9:30 a.m.	Visit with the Exhibitors		International I

AT-A-GLANCE

Tuesday, October 7

Session Time	Presentation Title	Lead Presenter	Room
Concurrent Sessions IV			
9:30 a.m. - 10:45 a.m.	GED Academy - Preparing for Success in 2014 (EXHIBITOR)	Stephanie Eichner	Augusta A
9:30 a.m. - 10:45 a.m.	Analyzing ESL/ABE Comprehension Questions to Address College and Career Readiness	Lori Howard	Augusta B
9:30 a.m. - 10:45 a.m.	Engaging Your Students in Health and Financial Education	Greg Smith	Colonial A
9:30 a.m. - 10:45 a.m.	College and Career Readiness for Academic Skills	Philip Anderson	Colonial B
9:30 a.m. - 10:45 a.m.	Integrating Technology into the Correctional Setting	Jack Summers	Congressional A
9:30 a.m. - 10:45 a.m.	Components of Numeracy: Tools for Engaging Learners in Meaningful Math (Part 1)	Brooke Ista	Congressional B
9:30 a.m. - 10:45 a.m.	Emerging Technologies in the Adult Education Classroom (Part 1)	Steve Quann	Royal Dublin A (Computer Lab)
9:30 a.m. - 10:45 a.m.	Teenagers in the Classroom: Working with Younger Students in Adult Education	Lindsay Simpson	Royal Dublin B
9:30 a.m. - 10:45 a.m.	Data Reporting - Best Practices of Reporting Instructional Hours and LCP's (Part 1)	Tara McLarnon	Royal Melbourne A
9:30 a.m. - 10:45 a.m.	Strategies to Improve Student Readiness Leading to Transition to Postsecondary Education	Katrina Bell	Royal Melbourne B
9:30 a.m. - 10:45 a.m.	CASAS eTests and TOPSpro Update	Linda Taylor	Wentworth
10:45 a.m. - 11:00 a.m.	Visit with the Exhibitors		International I
Concurrent Sessions V			
11:00 a.m. - 12:15 p.m.	Adult Basic Education Open Forum	Ila Waite-Burns	Augusta A
11:00 a.m. - 12:15 p.m.	The Mystery of Adult Non-Participation in Education: Where are the Clues?	Margaret Patterson	Augusta B
11:00 a.m. - 12:15 p.m.	U.S. Immigration Policy, School Enrollment Issues for Immigrant Students, and Requirements for English Language Learners in Public Schools: What Adult Educators Should Know (Repeat Session)	Roger Rosenthal	Colonial A
11:00 a.m. - 12:15 p.m.	Reading Comprehension: Component Skills Matter	Adrienne Barnes	Colonial B
11:00 a.m. - 12:15 p.m.	Moving Beyond the Basics (EXHIBITOR)	Leslie Adkins	Congressional A
11:00 a.m. - 12:15 p.m.	Components of Numeracy: Tools for Engaging Learners in Meaningful Math (Part 2)	Brooke Ista	Congressional B
11:00 a.m. - 12:15 p.m.	Emerging Technologies in the Adult Education Classroom (Part 2)	Steve Quann	Royal Dublin A (Computer Lab)
11:00 a.m. - 12:15 p.m.	Do/Say Charts - A Key to Learners' Success	Jayne Adelson-Goldstein	Royal Dublin B
11:00 a.m. - 12:15 p.m.	Data Reporting - Best Practices of Reporting Instructional Hours and LCP's (Part 2)	Tara McLarnon	Royal Melbourne A
11:00 a.m. - 12:15 p.m.	3-in-1: The Circle of Math	Richard Jones	Royal Melbourne B
11:00 a.m. - 12:15 p.m.	Write the Lesson Plan for Your Retirement (EXHIBITOR) (Repeat Session)	Fred Espro	Wentworth
12:15 p.m. - 1:15 p.m.	"Power Up" Luncheon Sponsored by CTB/McGraw-Hill and McGraw-Hill Contemporary		International III

Tuesday, October 7

Session Time	Presentation Title	Lead Presenter	Room
Concurrent Sessions VI			
1:30 p.m. - 2:45 p.m.	Mentoring - A Push in the Right Direction	Donna Roberts	Augusta A
1:30 p.m. - 2:45 p.m.	Performance Level Descriptors: Empowering Teachers and Students	Daphne Atkinson	Augusta B
1:30 p.m. - 2:45 p.m.	Administrators #911 - HELP is a Click Away!	IPDAE Team	Colonial A
1:30 p.m. - 2:45 p.m.	Career, Collaboration and Community Connectivity: 4 C's of Real Success	Marie Cloutier	Colonial B
1:30 p.m. - 2:45 p.m.	From Principles to Practice in ESOL Reading and Vocabulary Development (Repeat Session)	Joe McVeigh	Congressional A
1:30 p.m. - 2:45 p.m.	Trade Books in the Adult Classroom	Jill Kettler	Congressional B
1:30 p.m. - 2:45 p.m.	Interactive Software Programs for Pronunciation, Listening, Speaking, and Vocabulary	Marsha Chan	Royal Dublin A (Computer Lab)
1:30 p.m. - 2:45 p.m.	Conversation Strategies for ESOL	Toni Molinaro	Royal Dublin B
1:30 p.m. - 2:45 p.m.	How to Flip Your Classroom (Repeat Session)	John Meyer	Royal Melbourne A
1:30 p.m. - 2:45 p.m.	Want to Help Your ABE and ESOL Students Read Better? (EXHIBITOR)	Claire Valier	Royal Melbourne B
1:30 p.m. - 2:45 p.m.	Write the Lesson Plan for Your Retirement (EXHIBITOR) (Repeat Session)	Fred Espro	Wentworth
2:45 P.M. - 3:15 P.M.	Exhibitor Break and Refreshments		International I
Concurrent Sessions VII			
3:15 p.m. - 4:30 p.m.	Bullying: Not Just for Kids	Karen Varney	Augusta A
3:15 p.m. - 4:30 p.m.	Changing Teachers and Classroom Practice to Reflect a Growth Mindset (EXHIBITOR)	Janis Williams	Augusta B
3:15 p.m. - 4:30 p.m.	Get Your Students Excited by Utilizing Career Pathways as a Classroom Management and Instructional Tool!	Kristina Hartman	Colonial A
3:15 p.m. - 4:30 p.m.	Grants Management, Contract Service Agreements, and Compliance	Harriett Abrams	Colonial B
3:15 p.m. - 4:30 p.m.	From Principles to Practice in ESOL Reading and Vocabulary Development (Repeat Session)	Joe McVeigh	Congressional A
3:15 p.m. - 4:30 p.m.	College and Career Readiness Review Program	Julie Falt Dicks	Congressional B
3:15 p.m. - 4:30 p.m.	DOK - Depth of Knowledge in the Adult ESOL Classroom	Veronica Pavon-Baker	Royal Dublin A (Computer Lab)
3:15 p.m. - 4:30 p.m.	Adult High School Open Forum	Marcia Maxwell	Royal Dublin B
3:15 p.m. - 4:30 p.m.	How to Flip Your Classroom (Repeat Session)	John Meyer	Royal Melbourne A
3:15 p.m. - 4:30 p.m.	Burlington English ICL - Engage Your Students with Standards-Based, Interactive Lessons! (EXHIBITOR)	Robert Breitbard	Royal Melbourne B
3:15 p.m. - 4:30 p.m.	Promoting Critical Thinking Skills in the Adult ESOL Classroom (EXHIBITOR)	Cindy Le	Wentworth
5:00 p.m. - 6:00 p.m.	FATDEC General Membership Meeting	Kimberly Gates	Wentworth
5:00 p.m. - 7:00 p.m.	Dinner on your own		
7:00 p.m. - 11:00 p.m.	President's Reception, Dance and Casino Night Sponsored by Houghton Mifflin Harcourt		International II

AT-A-GLANCE

Wednesday, October 8

Session Time	Presentation Title	Lead Presenter	Room
8:00 a.m. - 11:00 a.m.	Registration		International Ballroom Foyer
8:00 a.m. - 8:30 a.m.	Morning Coffee		International II
Administrators' Meeting			
8:30 am - 11:45 am	Administrators Meeting Agenda		International II
	Workforce Innovation and Opportunities ACE (WIOA) Title II	Kathleen Taylor	
	Budget	Tara Goodman	
	2014 Legislative Update	Tara Goodman	
	Adult Education Program Update	Zelda Rogers	
	Data/NRS	Tara McLarnon	
	GED® Testing	Tara Goodman	
	Washington Update: Federal Policy and ABE/ESL	Rachel Unruh	
	Career Source	Chris Hart	
	ACE Updates: Empowering Administrators through Legislative Advocacy, Professional Development, Information and Resources	Marc Hutek, Dave Barnes, Jon Conley	
Teacher Track I			
8:30 a.m. - 10:00 a.m.	Explore Paired Reading: Developing Reading Strategies which Prepare Learners for College and Career	Lori Howard	Congressional B
8:30 a.m. - 10:00 a.m.	TABE Online Training (Part 1) Must be pre-registered and have ticket to attend.	Michael Johnson	Royal Dublin A (Computer Lab)
8:30 a.m. - 10:00 a.m.	Understanding Constructed Response	Daphne Atkinson	Royal Dublin B
8:30 a.m. - 10:00 a.m.	Rubrics Revealed - Demystifying the Marvels of Performance-Based Formative Assessment in ESL Classes (Part 1)	Jayne Adelson-Goldstein	Royal Melbourne A
8:30 a.m. - 10:00 a.m.	Learning to Achieve (Part 1)	Roberta Reiss	Royal Melbourne B
8:30 a.m. - 10:00 a.m.	Hey Kermit...Now It's Easy Being Green!	Karen Varney	Wentworth
Teacher Track II			
10:15 a.m. - 11:45 a.m.	Tweet! Post! Blog! Pin! Using Social Media for Adult Education (EXHIBITOR)	Cindi Celske	Colonial A
10:15 a.m. - 11:45 a.m.	Extending the Classroom with Project Success: Success in the 21st Century (EXHIBITOR)	Michelle Velissariou	Congressional B
10:15 a.m. - 11:45 a.m.	TABE Online Training (Part 2) Must be pre-registered and have ticket to attend.	Michael Johnson	Royal Dublin A (Computer Lab)
10:15 a.m. - 11:45 a.m.	Rubrics Revealed - Demystifying the Marvels of Performance-Based Formative Assessment in ESL Classes (Part 2)	Jayne Adelson-Goldstein	Royal Melbourne A
10:15 a.m. - 11:45 a.m.	Learning to Achieve (Part 2)	Roberta Reiss	Royal Melbourne B
10:15 a.m. - 11:45 a.m.	Writing for the 2014 GED (EXHIBITOR)	Glenda Norvell	Wentworth
12:00 p.m. - 1:30 p.m.	ACE Awards Luncheon and Raffle		International III

2014 CONFERENCE COMMITTEE

Conference Chairman	Marc Hutek, President, ACE of Florida
Conference Coordinator	Valorie Boyd, Executive Director, ACE of Florida
ACE Membership Table	Jack Miller, Suzy McDowell, Nyce Daniels
Audio Visual	Emad Salem
Awards	Neeta Rancourt, Judy Johnson, Samantha Ertenberg, Maria Miranda, Julie Roberts, Leigh Ann Clark
Computer Lab	Emad Salem
Concurrent Sessions	Valorie Boyd, Julie Roberts
Exhibits	Julie Roberts
Local Arrangements	Beth Rattie, Andrew Jenkins
Marketing and Publicity	Valorie Boyd, Leigh Ann Clark, Julie Roberts
Membership	Leigh Ann Clark
Office Arrangements	Valorie Boyd, Leigh Ann Clark, Julie Roberts
On-Site Coordinators	Valorie Boyd, Julie Roberts, Leigh Ann Clark
Conference Volunteers	ACE Board Members, Marie Cloutier, Janet Richards, Druci Diaz
Presenter Check-In	Leigh Ann Clark, Julie Roberts, Charlotte Hall
Program Book	Valorie Boyd, Julie Roberts
Raffle	Judy Johnson, Jack Miller, Sylvia Turner, Dave Barnes
Registration	Leigh Ann Clark, Julie Roberts, Charlotte Hall
Signs	Marie Cloutier, Janet Richards, Druci Diaz
Sponsors	Julie Roberts
Volunteers	Victoria Ellis, Chair, Michelle Loango, Susan MacGill, Barbara Heaton, Debbie Sass, Sergei Paromchik

**New Readers Press offers solutions for all your
ADULT EDUCATION NEEDS**



- 2014 Test Prep
GED® | TASC™ | HISET™
- Reading and Writing
- Mathematics
- News for You
- Citizenship/ESOL
- Workplace
- Teacher Resources



800.448.8878

newreaderspress.com

SCHEDULE OF CONCURRENT SESSIONS

Sunday, October 5

ACE of Florida Board of Directors Meeting

Location: Royal Melbourne A
Time: 12:00 p.m. – 2:00 p.m.

Conference Registration Open

Location: International Ballroom I
Time: 1:00 p.m. – 6:00 p.m.

Exhibitor Set-up

Location: International Ballroom I
Time: 2:00 p.m. – 5:00 p.m.

Intensive Training Sessions

Reading Instruction Workshop for Adult Education

Time: 2:00 p.m. – 4:30 p.m.
Presenter(s): Claire Valier
Location: Royal Dublin B
Participants will learn and practice interactive activities to help students decode words of any length efficiently and fast. These strategies help students build essential skills necessary for strong fluency and comprehension with an explicit, systematic, multi-sensory approach. The research-based method supports a variety of instructional scaffolding models designed to rapidly move students from foundational skills into fluency improvement and reading comprehension.

Empowering All Adult Education Administrators for College and Career Readiness Standards

Time: 2:00 p.m. – 5:00 p.m.
Presenter(s): Zelda Rogers, IPDAE Team, Ila Waite-Burns
Location: Congressional A & B
Florida's adult educators are about to embark upon a critical statewide initiative directed at integrating College and Career Readiness Standards (CCRS) within Florida's ABE program. The implementation and on-going support of a systemic standards-driven instructional program begins with administrators who not only understand, but embrace the challenges faced by everyone when student outcome expectations are raised to the next level. Administrators will be presented with an overview of the national adult education standards movement, Florida State Standards and CCRS, along with the multi-year implementation plan. Administrators will gain insight into the depth of the CCRS, with specific focus on Florida's recently adopted ABE standards.

Dinner on your own

Time: 5:00 p.m. – 7:00 p.m.

Welcome to the Empowerment Zone Reception

Location: ChampionsGate Room (Lobby Level)
Time: 7:00 p.m. – 9:00 p.m.

Monday, October 6

Conference Registration Open

Location: International Ballroom I
Time: 7:30 a.m. – 11:45 a.m.
1:30 a.m. – 4:45 p.m.

Exhibit Hall Hours

Location: International Ballroom I
Time: 8:00 a.m. – 5:00 p.m.

Grand Opening of Exhibits and Continental Breakfast

Location: International Ballroom I
Time: 8:00 a.m. – 8:45 a.m.

Coffee and Breakfast Sandwich sponsored by: GED Testing Service

Grand Opening General Session

Location: International II
Time: 9:00 a.m. – 10:45 a.m.

Visit the Exhibits

Location: International Ballroom I
Time: 10:45 a.m. – 11:00 a.m.

CONCURRENT SESSIONS I 11:00 a.m. - 12:15 p.m.

TABE Update

Presenter(s): Jane Silveria
Location: Augusta A
This presentation is for persons that are already certified to administer the TABE and will fulfill the requirement for updating certification. Participants will be updated on recent changes in TABE and in legislation relating to the Career and Adult Education Division.

Transitioning Adult Learners and Non-Learners: US Findings from PIAAC

Presenter(s): Margaret Patterson
Location: Augusta B
Brand-new large-scale data from the international PIAAC Survey reveal much about low-level US adult learners and non-learners. This interactive session will share demographics and assessed skill levels of adults who left high school without completing and then later transitioned to postsecondary learning. It will also contrast findings on low-skilled learners with non-learners. Participants will identify resources for further information and will walk through findings graphically. The session will end with a recruitment simulation using findings.

Best Practices for Adult Learners to Catch Up, Keep Up, and Get Ahead by Using Digital Content (EXHIBITOR)

Presenter(s): Blythe Adreon, Barbara Heaton, Heidi Griffith
Location: Colonial A
Online and blended learning instructional models offer alternative ways to engage learners of all ages with a remarkable array of learning experiences, particularly for students who struggle in traditional classrooms. This session focuses on research-based steps teachers can take to maximize student learning in online and blended learning courses with first hand experiences from Hillsborough County's Adult Ed program. In addition, we will feature a program that will assist with addressing course content and quickly identifying where students are struggling and immediate intervention, allowing teachers to spend time communicating, connecting, facilitating, providing feedback, and ultimately helping all students learn.

Working Towards Student Success with Career Pathways

Presenter(s): Roxana Hurtado
Location: Colonial B
This session will provide participants with an overview of Miami-Dade's twelve-week Adult General Education Core Academic Bridge Course and the components that have led to increased student achievement.

Taking Care of Yourself: Making the Transition from Corrections to Work, Education, and Daily Life

Presenter(s): Anne Meisenzahl, Kimberlie Stralow, Charles Chatman

Location: Congressional A

Looking for easy to use, reproducible activities and lessons designed for ABE/ GED classes in and out of a corrections setting? Teachers will introduce a corrections curriculum including: GED subjects, alcohol and drugs, nutrition, parenting, housing and homelessness, as well as workforce readiness skills and transition to post-secondary education. Presenters will demonstrate how to use the corrections curriculum in various settings and will share sample lessons. The complete curriculum is available online.

CASAS Update

Presenter(s): Linda Taylor, Claire Valier, Veronica Pavon-Baker

Location: Congressional B

This session provides an update on what's new at CASAS, as well as a refresher for CASAS implementation in local programs. Topics include: overview of new features and reports for teachers, administrators and testers in CASAS eTests Online and TOPSpro Enterprise; changes related to CASAS assessment in FLDOE Assessment policy; free online self-paced CASAS initial and refresher training course overviews; new resources on the CASAS website; and other key points for a successful CASAS implementation.

www.floridaipdae.org

Presenter(s): IPDAE Team

Location: Royal Dublin A (Computer Lab)

Join the IPDAE team as we explore the totally new and innovated resource center developed especially for you, the adult educator. You will get a firsthand look at the new website and be able to navigate your way through a stress-free plug and play format. This workshop will enable you to explore new resources developed from the field of adult educators and for the field of adult educators.

Success of an Online, Learner Centered GED Prep Program (EXHIBITOR)

Presenter(s): Cindy Hewitt, Laura Kern

Location: Royal Dublin B

With diverse skills, prerequisite knowledge, and life demands, each student preparing for the GED® has unique needs. In this session, presenters will share the motivations, implementation, success and feedback of an online, learner-centered preparation program. Test candidates are provided interactive, online resources and layers of academic support to target their preparation efforts to their individual needs to successfully pass each of 2014 GED® tests – Reasoning through Language Arts, Mathematical Reasoning, Social Studies, and Science.

Civics in the ESL and GED Classrooms

Presenter(s): Chad Bryant

Location: Royal Melbourne A

This presentation is the fruit of several years of successful civics instruction at Tomlinson. We will discuss curriculum, appropriate textbooks & websites, guest speakers, and basic knowledge of USCIS procedures and immigration law. Finally, we will see how to employ these same principles to help students perform better on the social studies area of the GED.

Accommodations on High Stakes Tests (Repeat Session)

Presenter(s): John Hosterman

Location: Royal Melbourne B

Adult learners often need clarification about how to request accommodation on high stakes exams such as the GED Tests. In addition, many of these students may not be aware of the broad range of accommodations and assistive technologies that are currently available. This session will explain the process for requesting testing accommodations, the legal underpinnings of this process, and the range of accommodations and accessibility options that are potentially available to adult learners. *(This session will be repeated at 3:30 pm – 4:45 pm in Royal Melbourne B)*

English Discoveries Online - The Next-Generation Interactive Solution for English Language Learning (EXHIBITOR)

Presenter(s): Jill Rosolek, Stewart Holtz

Location: Wentworth

See the new and exciting things happening with English Discoveries Online: Career Discoveries – students can explore a wide variety of careers using multimedia content, answer leading questions that help them clarify their interests and learn career-based vocabulary. Automated Writing Evaluation – instant automated writing evaluation for all 68 writing practice activities in EDO. EDO-M – our mobile app that allows your students to supplement their English language learning on their smart phone or tablet.

Lunch on Your Own

Time: 12:15 p.m. – 1:30 p.m.

Monday, October 6

CONCURRENT SESSION II

1:45 p.m. - 3:00 p.m.

Mathematical Reasoning: Bringing Math to Life in Your Classroom

Presenter(s): Daphne Atkinson

Location: Augusta A

Why do many students hate math? One answer is that math seems to be a foreign language that many just don't understand. This session provides an overview of the critical reasoning skills for the 2014 GED® Mathematical Reasoning test that students need—and not just to pass the test but in acquiring skills for life. The session will also build instructor awareness of selected instructional techniques that can be used to develop key skills in algebraic and quantitative reasoning.

Integrating Career Awareness into Adult Basic Education & ESOL Classes

Presenter(s): Wendy Oliver, Felicia Boyd, Robin Oliver

Location: Augusta B

Promoting College and Career Ready Standards in Adult Basic Education forges a stronger link among adult education, postsecondary education, and the world of work. It presents a starting point for raising awareness and understanding of the critical skills and knowledge expected and required for success in colleges, technical training programs, and employment in the 21st century. In this presentation you'll learn tips to implement College & Career Readiness (CCR) standards by hearing OCPS' methods to raise awareness to transition ABE & ESOL students.

Online Vocabulary Quizzes and Vocabulary Profiling Tools

Presenter(s): Marsha Chan

Location: Colonial A

Corpus linguistics studies have identified vocabulary according to frequency and categorized words as more general or academic. Marsha presents free online vocabulary quizzes focusing on the 2,000 most frequent words in English. These interactive vocabulary exercises provide numerous uses of each high-frequency word in authentic contexts. She also introduces VocabProfile, which breaks texts down by word frequencies, and demonstrates how to match texts to learner vocabulary levels and analyze the lexicon of a learner's writing.

Approaching Your Multilevel ESOL Class

Presenter(s): Dawn Adolphson

Location: Colonial B

To a certain extent all ESOL classrooms are multilevel; however, what do you do when all levels are represented in one room? This presentation will review techniques on how to approach your multilevel ESOL class such as

grouping strategies, using technology, self-access materials, classroom management, assessment ideas, and how to motivate your students in this kind of environment. The techniques covered could also be applied to ABE or GED classes that are multilevel.

FSCJ Career Pathways Program

Presenter(s): Deana Waite

Location: Congressional A

This will be an overview of the career pathways program at Florida State College at Jacksonville. It will discuss creating common strands throughout the program and strengthening internal partnerships.

Creating e-Learning Strategies that Serve Adult Education Learners (EXHIBITOR)

Presenter(s): Cindi Celske

Location: Congressional B

Are you looking to develop an e-learning strategy for your adult education students? Ms. Celske, an e-learning specialist from Western Illinois University, will share findings from a survey of adult education programs. Learn which components influence the most success and the biggest challenges for an e-learning program. Shape these tips into your e-learning strategic plan to connect your program's instructional opportunities to the needs of today's 21st Century adult education students.

The OMB Omni Circular: What You Need to Know to Administer a Federal Grant (Part 1)

Presenter(s): Michael Brustein, Esq.

Location: International II

Michael Brustein will lead this discussion on the full array of significant changes to all of federal grants management. He will cover the new shift to performance metrics, risk assessment by the State, new rules on computers and equipment purchases, changes to procurement, new false claims certifications, requirements for written policies on cash management and allowability of costs under the AEFLA. If you are responsible for administering federal funds, you do not want to miss this session! (Part 2 of this session will continue at 3:30 - 4:45 pm in International II)

CPALMS Overview

Presenter(s): Meghan Hauptli

Location: Royal Dublin A (Computer Lab)

Discover the newly redesigned CPALMS platform, a free online toolbox of information, vetted high-quality resources, and interactive tools that help educators effectively implement the standards. CPALMS is the State of Florida's official source for standards information and course descriptions. Come and join the millions of users from around the world and learn how CPALMS can help ACE teachers.

What If Your Students Aren't GED Ready Yet? (EXHIBITOR)

Presenter(s): Deanna Crosson

Location: Royal Dublin B

Instructional strategies have shifted with the advent of the new GED® Test this year. Now that we have these in place, it's time to look at those students that fall into the 5th through 8th grade range. What do we need to teach these students? How do we need to teach these students to start getting them ready to move into a GED prep class? Using the new series of books and software from Houghton Mifflin Harcourt/Steck Vaughn, let us show you.

BurlingtonEnglish Practice for CASAS—Helping Students, Teachers, and Schools Gain LCPs (EXHIBITOR)

Presenter(s): Lori Wedner

Location: Royal Melbourne A

Have you heard the news? BurlingtonEnglish has been endorsed by CASAS to be an official partner with our new CASAS Preparation Course! In this session, you will discover why. Participants will learn how to use the BE Practice for CASAS program to assess students, identify needs, and target instruction.

You will get a view of practice tests, progress reports, and interactive In Class Lessons designed to help students master the competencies. This session is perfect for current users and anyone interested in gaining LCPs.

Exhibitor Break & Refreshments

Location: International Ballroom I

Time: 3:00 p.m. – 3:30 p.m.

Monday, October 6

CONCURRENT SESSIONS III

3:30 p.m. - 4:45 p.m.

Beyond Career Planning 101

Presenter(s): Ila Waite-Burns

Location: Augusta A

Are you looking for resources to enrich and diversify career planning with adults? Labor market information will motivate and inspire adults to explore postsecondary options. Participants will learn how current labor market information can be used to assist adult education students plan for high wage and high demand occupations. Your students will be saying, "show me the money".

The College and Career Readiness Standards - What Do They Mean for Adult ESOL Teachers?

Presenter(s): Philip Anderson, Yvonne Ward, Tiffaney Barnes

Location: Augusta B

This interactive session is primarily for Adult ESOL teachers. Participants will explore the overall impact that Common Core State Standards will have on adult ESOL. We will examine the CCR standards and use them to create sample lesson plans.

High Tech, Low Tech, No Tech Solutions

Presenter(s): Jane Kim, Jane Bravo

Location: Colonial A

Adult learners need to experience success immediately and frequently if they are to remain in our programs. Come explore how Palm Beach County implemented high tech, low tech and no tech solutions to ensure success for their students and staff at all levels.

GED® 2014: Florida and National Program Trends

Presenter(s): Tara Goodman, Daphne Atkinson, Diane Vaccari

Location: Colonial B

The GED® 2014 debuted in January. This session will provide an overview of the testing and performance trends that can be seen both here in Florida and nationally.

Career Pathways: Orientation and the Small District

Presenter(s): Melanie Stefanowicz, Anne Murphy, Ebenson

Michelin, Layne Goldman

Location: Congressional A

The MCSDD Career Pathways orientation focuses on strengthening connections between adult students' current classes and their postsecondary education plans or their current or future employment. While the Career Pathways Workshops are a vital part of learning during the Adult Education program, they can be challenging for a small district to implement. In this session, the Monroe County School District will share how it adapted a successful model to meet the demands of its community.

Teaching Verb Tense and Voice to Adult English Language Learners

Presenter(s): Sergei Paromchik

Location: Congressional B

Teaching grammar is an important part of Adult ESOL instruction. Grammar has to be taught using a communicative approach. Many Adult ESOL teachers do not have a background education in English. Just being a native speaker is not enough. Teaching grammar should be done in a systematic way. Adult ESOL teachers have to understand the grammar categories of tense and voice as a system. This presentation is focused on teaching a system of grammar tenses that ESOL teachers have to know and understand. It is based on Adult ESOL Florida Department of Education Curriculum Standards covering all ESOL levels, including academic skills. Knowledge of grammar tenses will help adult ESOL teachers teach ESOL more efficiently in accordance with College and Career readiness standards.

The OMB Omni Circular: What You Need to Know to Administer a Federal Grant (Part 2)

Presenter(s): Michael Brustein, Esq.

Location: International II

Michael Brustein will lead this discussion on the full array of significant changes to all of federal grants management. He will cover the new shift to performance metrics, risk assessment by the State, new rules on computers and equipment purchases, changes to procurement, new false claims certifications, requirements for written policies on cash management and allowability of costs under the AEFLA. If you are responsible for administering federal funds, you do not want to miss this session! (Part 2)

Sensible Soft Skills

Presenter(s): Anna Schubarth

Location: Royal Dublin A (Computer Lab)

Soft skills are teachable basic social skills required to live and work within society. This session will give an overview of the five core skills: leadership, teamwork, communication, money management and employability, with practical, hands-on activities that build real-world experience and confidence. Attendees will participate in a variety of soft skill activities and will receive access to an online (PDF) book containing complete lesson plans suitable for small group or classroom instruction.

U.S. Immigration Policy, School Enrollment Issues for Immigrant Students, and Requirements for English Language Learners in Public Schools: What Adult Educators Should Know (Repeat Session)

Presenter(s): Roger Rosenthal

Location: Royal Dublin B

This workshop, conducted by an attorney with extensive experience in immigration policy, school enrollment issues for immigrant students, and school language rights issues, will focus on the following topics: Enrollment Issues for Immigrant Students in Florida Public Schools; the requirements regarding ESOL for English Language Learners in the K-12 public schools; Immigrant Access to Post-Secondary Education; the Deferred Action for Childhood Arrivals (DACA) program; Legalization of currently undocumented individuals/The Prospects for Immigration Reform; the basis for granting refugee or asylee status under U.S. immigration law; Issues surrounding the recent influx of Central American children and youth. (This session will be repeated on Tuesday, 11:00 a.m. – 12:15 p.m. in Colonial A)

How to Use Social Media to Promote Your Programs

Presenter(s): Jeff Arnott, Todd Forschino

Location: Royal Melbourne A

Social Media is a driving force in business and education. Learn how you can use these powerful tools to promote your programs and to engage with other educators from around the world.

Accommodations on High Stakes Tests (Repeat Session)

Presenter(s): John Hosterman

Location: Royal Melbourne B

Adult learners often need clarification about how to request accommodation on high stakes exams such as the GED Tests. In addition, many of these students may not be aware of the broad range of accommodations and assistive technologies that are currently available. This session will explain the process for requesting testing accommodations, the legal underpinnings of this process, and the range of accommodations and accessibility options that are potentially available to adult learners. (This presentation is a repeat session from 11:00 a.m. – 12:15 p.m.)

TABE Meeting

Presenter(s): Jane Silveria

Location: Wentworth

This TABE meeting is for current state trainers.

Ice Cream Social and Bingo with the Board (Bring your ticket)

Location: International Ballroom III

Time: 5:00 p.m. – 6:30 p.m.

Sponsored by: Edgenuity

Get to know your ACE Board of Director representative. Each ACE Board member will have a "table" area with a stanchion that has their name and the ACE district number on it. When attendees enter the Ice Cream Social, they will come to the "table area" for their ACE district. During this time, bingo will be played and prizes will be awarded to the winners of each game. At the end of the social, all members of the ACE district that has the most individual Bingo winners, will also win a prize.

Dinner on your own

Time: 6:30 p.m.

Tuesday, October 7

Conference Registration Open

Location: International Ballroom I

Time: 7:30 a.m. – 12:15 p.m.

1:15 p.m. – 4:30 p.m.

Exhibit Hall Visitation with Coffee and Pastries

Location: International Ballroom I

Time: 8:00 a.m. – 8:30 a.m.

Exhibit Hall Hours

Location: International Ballroom I

Time: 8:00 a.m. – 3:30 p.m.

Special General Session: ACE of Florida's Best Practices Round-up Roll-out

Location: International Ballroom II

Time: 8:30 a.m. – 9:15 a.m.

Round up your colleagues and head on over to the International Ballroom II coral to hear the latest on the ACE of Florida's Best Practices Roll-out. Last February, 150 adult educators from around the state gathered at the Best Practices Collaboration Round-Up. School districts and state colleges were invited to send a team of practitioners to a hands-on workshop to compile a comprehensive overview of best practices in Florida's adult education. Participants were divided into teams representing their program focus of expertise. The groups identified best practices for ABE/GED/Credit; ESOL; Administrators; Transition; and Grants. The best practices from the Round-Up have now been compiled and published in a resource book. Each ACE Conference attendee will receive a printed copy of the compilation of Best Practices and will learn how to access these valuable teaching tips on the ACE of Florida Best Practices Wiki.

Visit with the Exhibitors

Location: International Ballroom I

Time: 9:15 a.m. – 9:30 a.m.

Tuesday, October 7

CONCURRENT SESSIONS IV

9:30 a.m. - 10:45 a.m.

GED Academy - Preparing for Success in 2014 (EXHIBITOR)

Presenter(s): Stephanie Eichner

Location: Augusta A

GED Academy is a technology-based program to prepare students for the 2014 GED. There is a CD version for sites without internet access. GED Academy is aligned with the College and Career Readiness Standards and includes lessons on digital literacy skills, the TI scientific calculator, advanced algebra content, and extended response writing. There are two 2014 practice tests embedded in the program. Our Essential Skills workbook series complements GED Academy.

Analyzing ESL/ABE Comprehension Questions to Address College and Career Readiness

Presenter(s): Lori Howard

Location: Augusta B

Citing textual evidence is one of the key instructional shifts for college and career readiness. This shift promotes higher-order thinking and requires learners to analyze information, cite evidence, and defend opinions based on the text they have read. By the end of this session, participants will be able to: demonstrate understanding of the instructional shift-Textual Evidence, analyze comprehension questions, enhance existing questions to be more effective and develop additional text-dependent comprehension questions.

Engaging Your Students in Health and Financial Education

Presenter(s): Greg Smith

Location: Colonial A

Adults with limited English language and literacy skills often face significant challenges when it comes to making informed decisions about their health and finances. They may struggle to understand medication instructions, nutrition labels or the meaning of a credit report. Adult education programs are uniquely positioned to integrate health and financial information into their instruction in a truly impactful way. This session will discuss evidence-based curriculum and program models that have worked for others. Each participant will receive the newly released publication "Staying Healthy for Beginners".

College and Career Readiness for Academic Skills

Presenter(s): Philip Anderson, Yvonne Ward, Tiffaney Barnes

Location: Colonial B

This interactive session is primarily for Adult ESOL teachers. Participants will learn about changes in the FLDOE Adult ESOL Academic Skills curriculum taking effect July 1, 2015. Attendees will explore links between the Academic Skills curriculum and the CCR Standards and create sample lesson plans.

Integrating Technology into the Correctional Setting

Presenter(s): Jack Summers

Location: Congressional A

How the Education Department at Liberty Correctional Institution is integrating Technology into the 2014 GED through the use of the the Promethean Board and other computer-based training tools.

Components of Numeracy: Tools for Engaging Learners in Meaningful Math (Part 1)

Presenter(s): Brooke Istas

Location: Congressional B

Participants in this hands-on workshop will explore ways to add context to the math content already being taught in classrooms and to develop learners' reasoning and problem solving skills. Teachers will learn to design and enhance instructional activities that meet the needs of learners of all levels and will enhance learners' ability to apply the math content in a variety of real-life contexts. (Part 2 of this presentation will continue at 11:00 a.m. – 12:15 p.m. in Congressional B.)

Emerging Technologies in the Adult Education Classroom (Part 1)

Presenter(s): Steve Quann

Location: Royal Dublin A (Computer Lab)

This two-part session provides a hands-on opportunity to explore the availability and use of emerging technologies (Web 2.0, etc.) in the adult education classroom. The session highlights several resources related to these technologies and how they can be used by participants in their instruction. Participants should plan on attending both sessions. (Part 2 of this presentation will continue at 11:00 a.m. – 12:15 p.m. in Royal Dublin A.)

Teenagers in the Classroom: Working with Younger Students in Adult Education

Presenter(s): Lindsay Simpson

Location: Royal Dublin B

The increase of students under 18 years old has presented new and unique obstacles for adult education instructors. Addressing the needs of younger students and incorporating them into an already diverse population can prove challenging. This session will discuss ways to connect with the younger students in your class, motivate them to work toward success on the GED, and help them avoid the pitfalls that can affect adult education students.

Data Reporting - Best Practices of Reporting Instructional Hours and LCP's (Part 1)

Presenter(s): Tara McLarnon, Colin Barton

Location: Royal Melbourne A

This session will focus on the best practices of collecting and reporting instructional hours, learning completion points (LCP's) and test records. This session will cover the submission process, reporting windows, and common reporting issues. Attention will also be given to analysis of data for improving performance. (Part 2 of this presentation will continue at 11:00 a.m. – 12:15 p.m. in Royal Melbourne A.)

Strategies to Improve Student Readiness Leading to Transition to Postsecondary Education

Presenter(s): Katrina Bell

Location: Royal Melbourne B

This presentation will focus on activities that lead to more success in transitioning students into postsecondary education and will outline the incremental steps that can be taken in most adult education settings.

CASAS eTests and TOPSpro Update

Presenter(s): Linda Taylor, Veronica Pavon-Baker, Claire Valier

Location: Wentworth

This session presents the newest technology CASAS has to offer. The next generation of TOPSpro software and CASAS eTests is here. With CASAS eTests Online students can take an online test anywhere they can be proctored, and you can access their test scores and reports anywhere. Learn how TOPSpro Enterprise is also online and includes new features, such as filtering lists, dashboard indicators, and reports for teachers, administrators and testers with colorful charts and graphs.

Visit with the Exhibitors

Location: International Ballroom I
Time: 10:45 a.m. – 11:00 a.m.

Tuesday, October 7

Concurrent Sessions V

11:00 a.m. - 12:15 p.m.

Adult Basic Education Open Forum

Presenter(s): Ila Waite-Burns

Location: Augusta A

Join Florida's ABE practitioners and administrators for an energizing discussion about program initiatives and topics that impact an ABE program. Discussion topics, intended to promote best practices and thought provoking conversations, include program standards, career planning, and instruction.

The Mystery of Adult Non-Participation in Education: Where are the Clues?

Presenter(s): Margaret Patterson

Location: Augusta B

While the US economy recovers, the need for adults to be prepared for family-sustaining careers is acute. Yet millions of Americans have ended their educational experiences, perhaps permanently, after leaving high school without completing. New large-scale national data provide clues as to how. This session will share characteristics, skill levels, and other findings on adult non-learners. Participants will have the opportunity to inform proposed research and discuss important implications for recruiting non-learners back to learning.

U.S. Immigration Policy, School Enrollment Issues for Immigrant Students, and Requirements for English Language Learners in Public Schools: What Adult Educators Should Know (Repeat Session)

Presenter(s): Roger Rosenthal

Location: Colonial A

This workshop, conducted by an attorney with extensive experience in immigration policy, school enrollment issues for immigrant students, and school language rights issues, will focus on the following topics: Enrollment Issues for Immigrant Students in Florida Public Schools; the requirements regarding ESOL for English Language Learners in the K-12 public schools; Immigrant Access to Post-Secondary Education; the Deferred Action for Childhood Arrivals (DACA) program; Legalization of currently undocumented individuals/The Prospects for Immigration Reform; the basis for granting refugee or asylee status under U.S. immigration law; Issues surrounding the recent influx of Central American children and youth.

Reading Comprehension: Component Skills Matter

Presenter(s): Adrienne Barnes

Location: Colonial B

An examination of the relations between component skills of reading and standardized reading comprehension assessments such as the TABE Reading and the Woodcock Johnson III Passage Comprehension will be followed by practical suggestions for instruction of fundamental skills, suggested resources for instruction, and a glimpse into what eye movement technology is beginning to reveal about struggling adult readers.

Moving Beyond the Basics (EXHIBITOR)

Presenter: Leslie Adkins

Location: Congressional A

This session will discuss the history of Adult Basic Education and why and how it has transformed. Discussion about new standards, assessments and increased rigor will assist adult educators in implementing these new expectations and outcomes into their classroom.

Components of Numeracy: Tools for Engaging Learners in Meaningful Math (Part 2)

Presenter(s): Brooke Istas

Location: Congressional B

Participants in this hands-on workshop will explore ways to add context to the math content already being taught in classrooms and to develop learners' reasoning and problem solving skills. Teachers will learn to design and enhance instructional activities that meet the needs of learners of all levels and will enhance learners' ability to apply the math content in a variety of real-life contexts.

Emerging Technologies in the Adult Education Classroom (Part 2)

Presenter(s): Steve Quann

Location: Royal Dublin A (Computer Lab)

This two-part session provides a hands-on opportunity to explore the availability and use of emerging technologies (Web 2.0, etc.) in the adult education classroom. The session highlights several resources related to these technologies and how they can be used by the participants in their instruction. Participants should plan on attending both sessions.

Do/Say Charts - A Key to Learners' Success

Presenter(s): Jayme Adelson-Goldstein

Location: Royal Dublin B

Interpersonal skills are a strong determiner of our learners' success in academic, workplace and community settings. Do/Say charts, originally designed by Spencer Kagan, are an easy way for ESL and ABE instructors to help their learners practice the language and behaviors associated with various interpersonal skills. In this hands-on session, participants work with ready-made charts, develop charts for their own classroom, and discuss ways to monitor and expand on learners' use of these key skills.

Data Reporting - Best Practices of Reporting Instructional Hours and LCP's (Part 2)

Presenter(s): Tara McLarnon

Location: Royal Melbourne A

This session will focus on the best practices of collecting and reporting instructional hours, learning completion points (LCP's) and test records. This session will cover the submission process, reporting windows, and common reporting issues. Attention will also be given to analysis of data for improving performance.

3-in-1: The Circle of Math

Presenter(s): Richard Jones

Location: Royal Melbourne B

The presentation focuses on basic relationship concepts of math for fractions-to-decimals-to-percents: how to identify fractions; turn fractions into decimals; turn decimals into percents; and, percents back to fractions, which completes the "basic circle of math." The presentation will also highlight strategies for teaching varied learning styles within the presentation.

Write the Lesson Plan for Your Retirement (EXHIBITOR) (Repeat Session)

Presenter(s): Fred Espro

Location: Wentworth

Once you retire, properly converting assets into income is just as important as accumulating them. When you draw Social Security, it can have a big impact, and your retirement nest egg has to be carefully managed. Please join us at the seminar for recent and soon-to-be retirees and learn how to generate income after you have stopped earning it. (This presentation will be repeated at 1:30 p.m. - 2:45 p.m. in Wentworth.)

"Power-Up Luncheon"

(This is included in the registration conference fee. You must have your ticket to be admitted.)

Location: International Ballroom III

Time: 12:15 p.m. – 1:15 p.m.

Sponsored by: CTB/McGraw-Hill and McGraw-Hill Contemporary

Tuesday, October 7**CONCURRENT SESSIONS VI****1:30 p.m. - 2:45 p.m.****Mentoring - A Push in the Right Direction**

Presenter(s): Donna Roberts, Lydia Fowler, Clark Lewis

Location: Augusta A

Would you like to know how Indian River State College's ABE/GED Department plans to empower its students to succeed? Please join us as we share the implementation plan for our structured mentoring program. We will tell you about our River Guides and the important role that they play in the success of our ABE/GED students. River Guides strive to ensure that students are retained, complete and transition to college. The River Guides are a committee of individuals that use CHOICES, student advisement, community partnerships, and job fairs to ensure that all students have the tools and resources necessary to be successful. Most importantly, they build relationships while establishing a sense of community.

Performance Level Descriptors: Empowering Teachers and Students

Presenter(s): Daphne Atkinson

Location: Augusta B

This session provides an overview and basic introduction to the new 2014 GED® test's three performance levels: Level 1 (Below Passing), Level 2 (High School Equivalency), and Level 3 (GED Score with Honors). Find out how to access the PLDs; practice using a descriptor; and finally, take away practical recommendations for using the descriptors in your work with adult learners—at all levels.

Administrators #911 - HELP is a Click Away!

Presenter(s): IPDAE Team

Location: Colonial A

The IPDAE staff will unveil a new resource specifically designed to provide quick reference links to important FDOE and national adult education information. Participants will be invited to provide suggestions for future links considered helpful for administrative issues.

Career, Collaboration and Community Connectivity: 4 C's of Real Success

Presenter(s): Marie Cloutier, Janet Richards, Druci Diaz, Victoria Ellis

Location: Colonial B

As a new initiative, the Hillsborough County School District created a new concept bridging high school, adult and post-secondary education, the outside community and local social services agencies into an outreach component creating a "one stop shop." This connectivity has created a new career pathways initiative, in house guidance and career counseling, workforce development and employability resources which in turn create self-sufficient, EMPOWERED community members. You will gain resources which will assist in the implementation of this collaboration within your district.

From Principles to Practice in ESOL Reading and Vocabulary Development (Repeat Session)

Presenter(s): Joe McVeigh

Location: Congressional A

Reading is a complex skill that is critical to ESOL learners' language

development. In this interactive demonstration, we will start with a brief overview of current theories about how students learn to read. Then we will examine how these principles can be applied effectively in practical reading and vocabulary activities. At the conclusion, participants will leave with a menu of practical reading and vocabulary activities and knowledge of current principles in reading and vocabulary instruction. (This presentation will be repeated at 3:15 p.m. – 4:30 p.m. in Congressional A.)

Trade Books in the Adult Classroom

Presenter(s): Jill Kettler

Location: Congressional B

Spice up learning with Trade Books. Trade Books cover just about every topic under the sun. The primary reason for using a Trade Book in the classroom is to create interest. This presentation keys in on ways to use Trade Books in the adult classroom to meet curriculum standards.

Interactive Software Programs for Pronunciation, Listening, Speaking, and Vocabulary

Presenter(s): Marsha Chan

Location: Royal Dublin A (Computer Lab)

Many multimedia resources can help learners improve their English pronunciation, listening, speaking, and vocabulary skills. The presenter introduces a selection of software and websites that teachers and students can access in a classroom, lab and/or home, along with tips on how they can be used with beginning to advanced learners. After a highlight of the features of each of these outstanding and affordable content-rich resources, participants will have hands-on experience with programs of their choice.

Conversation Strategies for ESOL

Presenter(s): Toni Molinaro

Location: Royal Dublin B

In this presentation, you will learn how to teach conversation strategies to adult ESOL students leveled from low-intermediate to advance. Skills explicitly taught will be: How to start a conversation, how to end a conversation, how to use rejoinders to show understanding and emotion, how to engage in small talk topics, etc. Additionally, you will learn some unique approaches on how to engage students in conversation using Kehe's book, Conversation Strategies. If you teach any sort of conversation class to ESOL students, you should not miss this session!

How to Flip Your Classroom (Repeat Session)

Presenter(s): John Meyer

Location: Royal Melbourne A

We will explore how the flipped classroom concept changes routine, boring education, into a vibrant exchange of ideas and group learning that makes for a fascinating and memorable experience. We will also look at what defines a flipped classroom, why it is important, and how to implement this idea into your teaching environment. We will also look at examples of how others have benefited from flipping their teaching experience. (This presentation will be repeated on Tuesday at 3:15 p.m. – 4:30 p.m. in Royal Melbourne A.)

Want to Help Your ABE and ESOL Students Read Better? (EXHIBITOR)

Presenter(s): Claire Valier, Caroline McNair

Location: Royal Melbourne B

If your goal is to learn powerful strategies that will dramatically improve reading instruction, then this workshop is for you! Empower adult learners with a simple, streamlined approach for learning to read using a compelling, effective method to help students decode words of any length fast and efficiently. This proven method provides a strong foundation for ABE students and unlocks the code of English for ELLs leading to mastery of advanced reading skills.

Write the Lesson Plan for Your Retirement (EXHIBITOR) (Repeat Session)

Presenter(s): Fred Espro

Location: Wentworth

Once you retire, properly converting assets into income is just as important as accumulating them. When you draw Social Security, it can have a big impact, and your retirement nest egg has to be carefully managed. Please join us at the seminar for recent and soon-to-be retirees and learn how to generate income after you have stopped earning it. (This presentation is a repeat from 11:00 a.m. – 12:15 p.m. in Wentworth.)

Exhibitor Break and Refreshments

Location: International Ballroom I

Time: 2:45 p.m. – 3:15 p.m.

This is your last chance to visit the exhibitors. Come check out what they have to offer and enjoy some refreshments.

Tuesday, October 7

CONCURRENT SESSION VII

3:15 p.m. - 4:30 p.m.

Bullying: Not Just for Kids

Presenter(s): Karen Varney

Location: Augusta A

More and more reports are being made of Adult Bullying...or Workplace Bullying. It even happens to football players!! Has it happened to your students at school or in the workplace? Hear the latest research, survey results and give your student some coping skills to deal with bullies without losing their cool.

Changing Teachers and Classroom Practice to Reflect a Growth Mindset (EXHIBITOR)

Presenter(s): Janis Williams

Location: Augusta B

Attendees will learn about the powerful emerging research that shows that even modest interventions in student belief systems and learning environments can have a powerful and positive effect on student motivation and success. Attendees will learn about the key constructs of: malleability of intelligence, productive persistence, confidence, and interactions with peers and teachers. Attendees will participate in practical applications of these constructs.

Get Your Students Excited by Utilizing Career Pathways as a Classroom Management and Instructional Tool!

Presenter(s): Kristina Hartman, Jenny McDonald

Location: Colonial A

Are you having trouble motivating your students? This interactive session will provide tools and methods for identifying and utilizing student career goals to develop classroom activities and individual lessons. You can turn those less-than-desirable topics into engaging, relevant lessons on the pathway to your students' dream jobs. Learn techniques to motivate your students and get them excited about education!

Grants Management, Contract Service Agreements, and Compliance

Presenter(s): Harriett Abrams

Location: Colonial B

This session will serve as an introduction to the fundamental principles of state and federal education grants management. It will assist program administrators in understanding what is expected to operate in compliance with applicable state and federal law. It will additionally assist grant recipients on developing meaningful and measurable contractual service agreements pursuant to state and federal rules. The session will also provide an overview of quality assurance and compliance monitoring as related to adult education.

The information provided during this session will focus on the enhanced risk assessment which now includes the program improvement plan (PIP) for adult education.

From Principles to Practice in ESOL Reading and Vocabulary Development (Repeat Session)

Presenter(s): Joe McVeigh

Location: Congressional A

Reading is a complex skill that is critical to ESOL learners' language development. In this interactive demonstration, we will start with a brief overview of current theories about how students learn to read. Then we will examine how these principles can be applied effectively in practical reading and vocabulary activities. At the conclusion, participants will leave with a menu of practical reading and vocabulary activities and knowledge of current principles in reading and vocabulary instruction. (This presentation is a repeat session from Tuesday, 1:30 p.m. – 2:45 p.m. in Congressional A.)

College and Career Readiness Review Program

Presenter(s): Julie Falt Dicks, Caronne Rush, Angela McQueen

Location: Congressional B

Several aspects of the Santa Fe College Adult Education Program will be highlighted: College and Career Readiness Classes; Concurrent Enrollment in Certification Training and Adult Education/GED classes; Contextualized adult education classes which highlight workplace readiness, computer and typing skills, and financial management; and college and community partnerships.

DOK - Depth of Knowledge in the Adult ESOL Classroom

Presenter(s): Veronica Pavon-Baker

Location: Royal Dublin A (Computer Lab)

A closer look in making the connection between developing language strategies for English Language Learners (ELLs) and CASAS by engaging students with challenging tasks based on levels of knowledge.

Adult High School Open Forum

Presenter(s): Marcia Maxwell, Zelda Rogers

Location: Royal Dublin B

Open discussion and networking for those who work with online or face to face adult high school programs as well as co-enrolled credit programs. It's an open forum so bring your questions and promising practices to share. State policies regarding graduation requirements and other issues will be discussed.

How to Flip Your Classroom (Repeat Session)

Presenter(s): John Meyer

Location: Royal Melbourne A

We will explore how the flipped classroom concept changes routine, boring education, into a vibrant exchange of ideas and group learning that makes for a fascinating and memorable experience. We will also look at what defines a flipped classroom, why it is important, and how to implement this idea into your teaching environment. We will also look at examples of how others have benefited from flipping their teaching experience. (This presentation is a repeat session from Tuesday at 1:30 p.m. – 2:45 p.m. in Royal Melbourne A.)

Burlington English ICL - Engage Your Students with Standards-Based, Interactive Lessons! (EXHIBITOR)

Presenter(s): Robert Breitbard

Location: Royal Melbourne B

Get a look at the newest addition to Burlington English—In Class Lessons! ICL provides teachers with interactive, standards-based lessons that will get students speaking and participating with projectable activities that include stimulating pictures, discussion starters, and games. Teachers can work through lessons with students as a whole class or dig deeper with small groups of struggling students. ICL will engage students of all levels. This session is perfect for current users and anyone interested in this powerful new teaching tool!

Promoting Critical Thinking Skills in the Adult ESOL Classroom (EXHIBITOR)

Presenter(s): Cindy Le

Location: Wentworth

Critical Thinking... What is it? Why is it important? How do you teach it? This workshop will provide a rationale for developing critical thinking skills in the Adult ESOL classroom and demonstrate ways teachers can challenge their students to think critically and at the same time develop their English language fluency using a variety of National Geographic Learning materials. Sample materials provided.

5:00 p.m. - 6:00 p.m.

FATDEC General Membership Meeting

Presenter(s): Kimberly Gates, Joan Luebke

Location: Wentworth

Time: 5:00 p.m. - 6:00 p.m.

The Florida Adult & Technical Distance Education Consortium (FATDEC) represents state colleges, schools, and school districts, delivering high-quality instructor-facilitated online adult education and career/technical courses for adult students. By working together, we're able to leverage our collective buying power and provide services to students who might otherwise not have an option for education. Come meet our members, learn more about what we do, and find out how you could be a part of this collaborative, innovative group!

Dinner on your own

Time: 5:00 p.m. - 7:00 p.m.

President's Reception, Dance and Casino Night

Location: International Ballroom I

Time: 7:00 p.m. - 11:00 p.m.

You must have your ticket to be admitted.

Sponsored by: Houghton Mifflin Harcourt

Wednesday, October 8

Conference Registration Open

Location: International Ballroom Foyer

Time: 8:00 a.m. - 11:00 a.m.

Morning Coffee

Location: International Ballroom II

Time: 8:00 a.m. - 8:30 a.m.

Administrator's Meeting

Time: 8:30 am - 11:45 am

Location: International Ballroom II

Agenda for the Administrators' Meeting

1. FLDOE, Division of Career and Adult Education Updates

Workforce Innovation and Opportunities Act (WIOA) Title II

Budget

2014 Legislative Update

Adult Education Program Updates

Data/NRS

GED® Testing

Presenter: Kathleen Taylor

Presenter: Tara Goodman

Presenter: Tara Goodman

Presenter: Zelda Rogers

Presenter: Tara McLarnon

Presenter: Tara Goodman

2. Washington Update: Federal Policy and ABE/ESL

Presenter: Rachel Unruh, Associate Director, National Skills Coalition
Recent policies and initiatives out of Washington mean new opportunities for

ABE/ESL delivery. And certain policies likely to be addressed in 2015 could greatly impact the field. This session will explore ABE/ESL opportunities in the recent White House Job-Driven Training Action Plan, the Workforce Innovation and Opportunity Act (WIOA), and SNAP Employment & Training. It will also look ahead to potential action on immigrant integration and higher education and how these policies will impact ABE/ESL.

3. CareerSource Florida: Working Together with Florida's Adult Education

Presenter: Chris Hart, President and CEO, CareerSource Florida

CareerSource Florida is the public-private workforce policy and investment board led by business and charged with developing strategies and policies for Florida's workforce system. CareerSource Florida network consists of the state policy and investment board, 24 regional workforce boards, and oversees nearly 100 career centers and the Department of Economic Opportunity.

4. ACE of Florida Updates: Empowering Administrators through Legislative Advocacy, Professional Development, Information and Resources

Presenter(s): Marc Hutek, President, ACE of Florida; Dave Barnes, Chairman, ACE Legislative Committee; Jon Conley, Director of Policy and Research, Emergent Design and Development and ACE of Florida's Legislative Consultant.

Wednesday, October 8

TEACHER TRACK I

8:30 a.m. - 10:00 a.m.

Explore Paired Reading: Developing Reading Strategies which Prepare Learners for College and Career

Presenter(s): Lori Howard

Location: Congressional B

High-interest, paired readings help students develop and expand their reading strategies, cross-cultural awareness and critical literacy skills - important elements of academic success and college and career readiness. Presenter demonstrates the key steps in creating, preparing and teaching paired reading lessons. Participants experience and explore paired reading lessons. Sample readings and lesson plans provided.

TABE Online Training (Part 1)

(*Pre-registration is a must. You must have a ticket to attend this session. Limited to 25 participants.)

Presenter(s): Michael Johnson

Location: Royal Dublin A (Computer Lab)

TABE Online is an easy-to-use, Web-based assessment and reporting system of adult basic education skills. It provides reliable skill-level data for adult educators to screen and place students in training or employment programs or to determine readiness for success on High School Equivalency Tests. Simply speaking, TABE Online provides reliable information on your adult students' skills, and enables you to meet their needs more quickly and effectively. (Part 2 of this presentation will continue at 10:15 a.m. - 11:45 a.m. in Royal Dublin A.)

Understanding Constructed Response

Presenter(s): Daphne Atkinson

Location: Royal Dublin B

Take a dive into the essential skills that students need for success and a range of instructional techniques you can use to develop skills in argumentative writing and using evidence. The workshop will include an opportunity to discuss these instructional techniques and how to integrate them in your classroom.

Rubrics Revealed - Demystifying the Marvels of Performance-Based Formative Assessment in ESL Classes (Part 1)

Presenter(s): Jayme Adelson-Goldstein

Location: Royal Melbourne A

This workshop provides opportunities to explore, experience and create a variety of rubrics for all levels of ESL. In addition, participants discuss the role learners can play in rubric creation and the role that rubrics play in developing learners' higher-order thinking skills. By the end of this workshop, participants will be able to discriminate between and select from analytic and holistic rubrics for instructional planning and assessment; use ready-made rubrics to provide effective feedback and quantify learners' qualitative performance; create an analytic rubric for a specific lesson; and use holistic rubrics to help differentiate instruction. A Rubrics Revealed Wiki for all workshop participants serves as a forum for sharing and discussing rubrics created during the school year and includes downloadable materials to support the use of rubrics in ESL instruction. (Part 2 of this presentation will continue at 10:15 a.m. – 11:45 a.m. in Royal Melbourne A.)

Learning to Achieve (Part 1)

Presenter(s): Roberta Reiss

Location: Royal Melbourne B

Learning to Achieve is designed to build teacher effectiveness in providing instruction for adults with LD. During this 3-hour session we will explore Learning to Achieve online resources as well as topics including Definitions of Learning Disabilities, Self-Determination, Legal Issues, and Explicit Instruction for Strategy Learning for learners with reading and written expression disabilities. (Part 2 of this presentation will continue at 10:00 a.m. – 11:45 a.m. in Royal Melbourne B.)

Hey Kermit...Now It's Easy Being Green!

Presenter(s): Karen Varney, Jan Lichtenwalter

Location: Wentworth

Ecology and environmental stewardship have become more and more critical, and the responsibility of all of us, not just the scientists. This will be an open forum, so bring your best thoughts and resources to share, to help our students learn how we can protect our earth and go easy on our wallets, too. We will bring vocabulary lists and strategies for learning new earth-friendly words.

Wednesday, October 8

TEACHER TRACK II

10:15 a.m. - 11:45 a.m.

Tweet! Post! Blog! Pin! Using Social Media for Adult Education (EXHIBITOR)

Presenter(s): Cindi Celske

Location: Colonial A

Are you currently using social media to stay in touch with your adult education students or to reach new potential learners? Come dive into some of the trending reasons why we should both teach with and utilize social media in our adult education programs. See first hand how i-Pathways uses social media to help it's adult education partners reach and teach better.

Extending the Classroom with Project Success: Success in the 21st Century (EXHIBITOR)

Presenter(s): Michelle Velissariou

Location: Congressional B

Rapid changes in our occupational and educational landscape compel language teaching to move beyond the print literacies. The presenters will identify key 21st Century skills and demonstrate how to integrate video and digital media in both classroom and independent learning so students learn all the skills they need to succeed.

TABE Online Training (Part 2)

(Pre-registration is a must. You must have a ticket to attend this session. Limited to 25 participants)

Presenter(s): Michael Johnson

Location: Royal Dublin A (Computer Lab)

TABE Online is an easy-to-use, Web-based assessment and reporting system of adult basic education skills. It provides reliable skill-level data for adult educators to screen and place students in training or employment programs or to determine readiness for success on High School Equivalency Tests. Simply speaking, TABE Online provides reliable information on your adult students' skills, and enables you to meet their needs more quickly and effectively.

Rubrics Revealed - Demystifying the Marvels of Performance-Based Formative Assessment in ESL Classes (Part 2)

Presenter(s): Jayme Adelson-Goldstein

Location: Royal Melbourne A

This workshop provides opportunities to explore, experience and create a variety of rubrics for all levels of ESL. In addition, participants discuss the role learners can play in rubric creation and the role that rubrics play in developing learners' higher-order thinking skills. By the end of this workshop, participants will be able to discriminate between and select from analytic and holistic rubrics for instructional planning and assessment; use ready-made rubrics to provide effective feedback and quantify learners' qualitative performance; create an analytic rubric for a specific lesson; and use holistic rubrics to help differentiate instruction. A Rubrics Revealed Wiki for all workshop participants serves as a forum for sharing and discussing rubrics created during the school year and includes downloadable materials to support the use of rubrics in ESL instruction.

Learning to Achieve (Part 2)

Presenter(s): Roberta Reiss

Location: Royal Melbourne B

Learning to Achieve is designed to build teacher effectiveness in providing instruction for adults with LD. During this 3-hour session, we will explore Learning to Achieve online resources as well as topics including Definitions of Learning Disabilities, Self-Determination, Legal Issues, and Explicit Instruction for Strategy Learning for learners with reading and written expression disabilities.

Writing for the 2014 GED (EXHIBITOR)

Presenter(s): Glenda Norvell

Location: Wentworth

Do your students need help with extended response and short answer prompts for the GED test? Writing for the GED Test is a three-part series that covers the language and writing instruction students need to construct extended responses and short answers. Students learn skills needed to write well-organized arguments for extended responses and supported short answers.

ACE Awards Luncheon and Raffle

This is included in the conference registration fee. You must have your ticket to be admitted.

Location: International Ballroom III

Time: 12:00 p.m. – 1:30 p.m.

i-Pathways: Learning Pathways in Adult Education

Empowering adult education students for high school equivalency test success!

- Online standards-based curriculum
- Basic through adult secondary education
- Accessible from any Internet-enabled device (from smart phones to desktops)
- Custom paths of learning make test-prep time more efficient
- Flexible delivery options: fully online, blended, face-to-face, or in classroom/lab settings
- Affordably priced reusable seat licenses



Contact us for a demo or to preview the curriculum:
309.298.1804 | info@i-pathways.org | i-pathways.org/2014

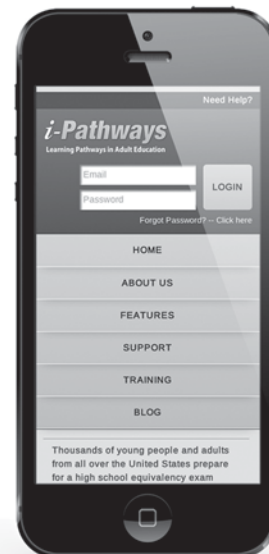

Other resources include:

Glossary of
Key Terms



Relevant
Web Links



Graphic
Organizers



Worksheets in
Math and
Writing



Extended
Response
Worksheets



Here's where learning clicks.

Real engagement. Real learning. Real results.

From engaging video-led direct instruction to meaningful real-world assignments, our online and blended learning programs are helping students become life-long learners. More than one million students agree: Edgenuity™ equals success.

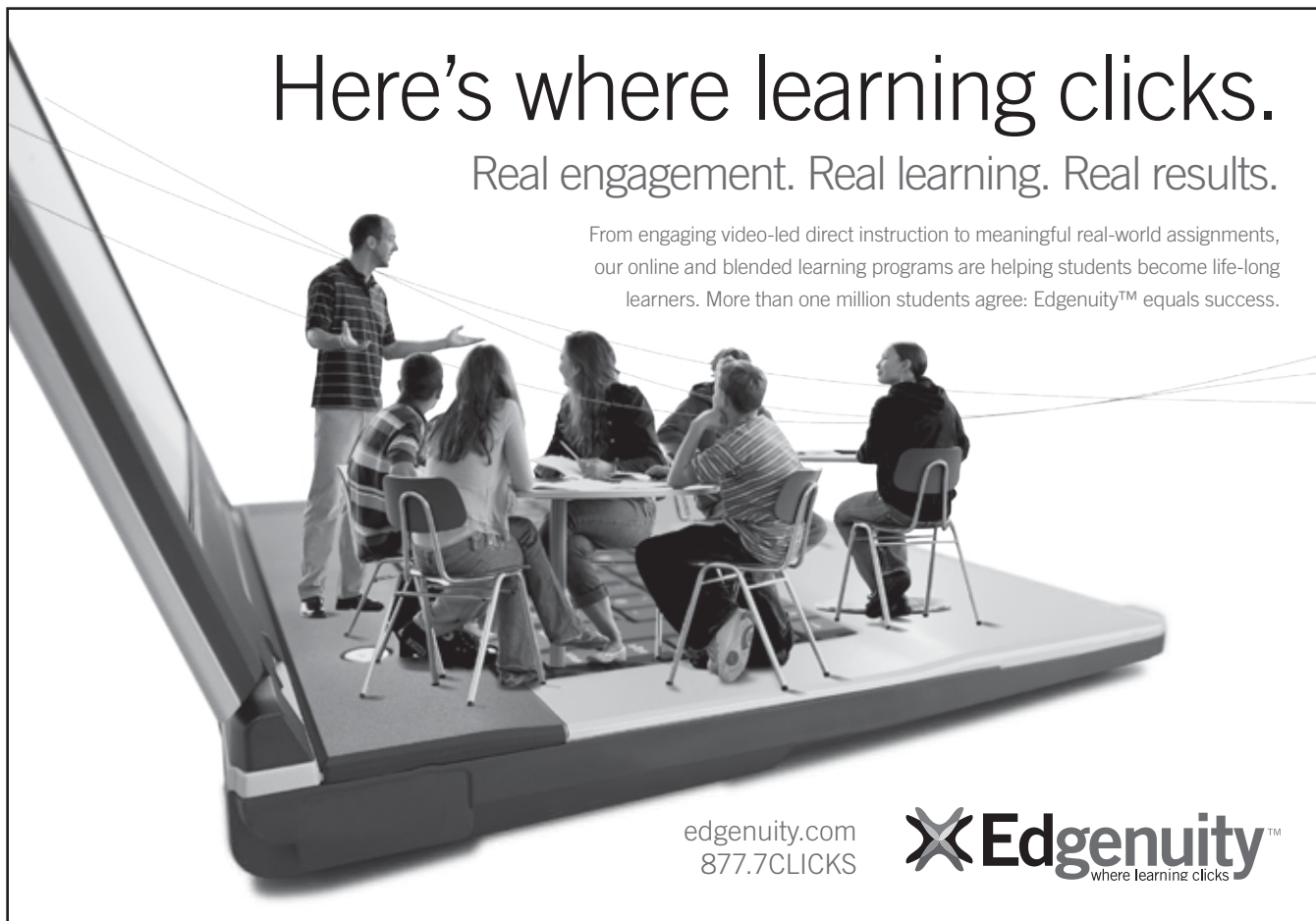

edgenuity.com
877.7CLICKS

 **Edgenuity**™
where learning clicks

2014 ACE CONFERENCE EXHIBITORS

AGILE MIND

1705 W. Northwest Highway, Suite 160
Grapevine, TX 76051

(321) 302-3059

Janis Williams, Director of Educational Partnerships
jwilliams@agilemind.com

Developed by Agile Mind and the Charles A. Dana Center in collaboration with leading psychologists, the Academic Youth Development program brings to practice the latest psychological and learning sciences research about student motivation and how changing students' perceptions of themselves as learners can transform learning outcomes. AYD equips teachers with effective tools and strategies to engage all students in rigorous academic content. AYD targets the key constructs of: malleability of intelligence, productive persistence, confidence, and interactions with peers and teachers.

AZTEC SOFTWARE

51 Commerce Street
Springfield, NJ 07081

(800) 273-0033

Adriana Fajnor, Director of Sales
sales@aztecsoftware.com

Aztec Software provides individualized, targeted, computer-based solutions, assisting adult learners with high school equivalency prep (GED® Test, HiSET® Test, TASC Test) and college prep solutions (ACCUPLACER®, Compass® and ACT). With Aztec Software, we help our learners achieve success in preparation for their post-secondary experience!

**BURLINGTON ENGLISH

1499 W. Palmetto Park Road, #103

Boca Raton, FL 33486

(305) 401-7850

Zevi Aber, President

Zevi.a@burlingtonenglish.com

Robert Breitbard, Director

Robert.b@burlingtonenglish.com

Lori Wedner, Customer Manager

Lori.w@burlingtonenglish.com

Claudia Llerandi, Customer Manager

Claudia.l@burlingtonenglish.com

Kim Bartholomew, Customer Manager

Kim.b@burlingtonenglish.com

Lauren Abraham, Customer Representative

Lauren.a@burlingtonenglish.com

BurlingtonEnglish is proud to present our new In Class Lessons. Aligned with Florida State Standards and CASAS, In Class Lessons enable teachers to make classroom lessons engaging and relevant while greatly reducing planning time. They complete the BurlingtonEnglish program and provide the perfect blend of face-to-face and online instruction to your students. Please visit our booth to see In Class Lessons – blended learning taken to the next level!

CAMBRIDGE UNIVERSITY PRESS

32 Avenue of the Americas

New York, NY 10013

(305) 409-5382

Susan Toth, Senior ESL/Classics Specialist

stoth@cambridge.org

Cambridge University Press - ESOL publisher of core programs including Ventures, Grammar and Beyond, Interchange, Passages, Four Corners, and Touchstone as well as professional development resources including the online network Cambridge English Teacher. Cambridge is also the sole distributor of McGraw Hill ESOL materials. Stop by and find out what's new!

COABE (COMMISSION ON ADULT BASIC EDUCATION)

P.O. Box 620

Syracuse, NY 13206

(888) 442-6223

Danielle Miles

dmiles@bscc.net

Kaye Sharbono, Regional Representative

ksharbono@ladelta.edu

Comprised primarily of administrators and teachers, COABE is 13,000 members strong and growing! Join our new LinkedIn group and download our FREE COABE App at www.coabe.org.

**CTB/MCGRAW-HILL

20 Ryan Ranch Road

Monterey, CA 93940

(954) 295-4212

Stephanie Seemann, Assessment Representative

Stephanie.seemann@ctb.com

SPONSOR

CTB is the leader in developing assessments for the adult basic education market. CTB assessments have passed rigorous reviews at the state and federal level, and for more than 45 years, the Tests of Adult Basic Education (TABE®) have been the premier measure of achievement used by educators, states, and employers to assess the knowledge and skills of adult learners.

**EDGENUITY

8860 E. Chaparral Road, Suite 100

Scottsdale, AZ 85250

(954) 445-9877

Heidi Griffith, Account Executive

Heidi.griffith@edgenuity.com

Blythe Adreon, Account Executive

Blythe.adreon@edgenuity.com

SPONSOR

Edgenuity provides engaging and flexible online and blended learning solutions that propel success for every student, empower every teacher to deliver more effective instruction, and enable schools and districts to meet their academic goals. Edgenuity delivers research-based, standards-aligned core curriculum, AP®, elective, career and technical education (CTE), and credit recovery courses. Please go to Edgenuity.com for more information.

ENGLISH DISCOVERIES ONLINE/ TECHNO-WARE

16258 Andalucia Lane

Delray Beach, FL 33446

(800) 469-9154

Stewart Holtz, President

stewartholtz@englishdiscoveriesonline.com

Jill Rosolek, Account Representative

Jill.rosolek@englishdiscoveriesonline.com

See the new and exciting things happening with English Discoveries Online: Career Discoveries – students can explore a wide variety of careers using multimedia content, answer leading questions that help them clarify their interests and learn career based vocabulary; Automated Writing Evaluation – instant automated writing evaluation for all 68 writing practice activities in EDO; EDO-M – our mobile app that allows your students to supplement their English language learning on their smart phone or tablet.

****Denotes Conference Sponsor**

2014 ACE CONFERENCE EXHIBITORS *cont'd*

ESSENTIAL EDUCATION – GED ACADEMY™

895 NW Grant Avenue
Corvallis, OR 97330
(800) 405-9109
Stephanie Eichner, Sales Representative
Stephanie@essentialed.com

Essential Education is proud to offer GED Academy™, a web-based instructional program to prepare your students for the 2014 GED®. There is also a CD version to serve sites without internet access. Essential Education also offers GED Ready™ and the Essential Skills workbook series.

FLORIDA ADULT AND TECHNICAL DISTANCE EDUCATION CONSORTIUM (FATDEC)

912 S. Martin Luther King, Jr. Blvd.
Tallahassee, FL 32301
(954) 560-7004
Kimberly Gates, Consortium Coordinator
Kim@fatdec.com
Joan Luebke, Past President
joan@fatdec.com

The Florida Adult and Technical Distance Education Consortium (FATDEC) is a group of public schools, school districts, and community/state colleges who are working together to deliver curriculum in a web-based environment for adult education and career technical programs in Florida's postsecondary public institutions.

FLORIDA LITERACY COALITION

250 N. Orange Avenue, Suite 1110
Orlando, FL 32801
(407) 246-7110
Kristine Babbish
babbishk@floridaliteracy.org
Greg Smith, Director
smithg@floridaliteracy.org

The Florida Literacy Coalition exhibit will feature information on FLC's programs and services, with a focus on Florida's Adult and Family Literacy Resource Center.

**GED TESTING SERVICE

1919 M. St. NW, 6th Floor
Washington, DC 20036
(202) 471-2201
Daphne Atkinson, Senior Director, State Relationships
Daphne.atkinson@gedtestingservice.com
Rafael Diaz, State Relationship Manager
Rafael.diaz@gedtestingservice.com

The 2014 GED® program has more of what you and your students need. Visit the GED Testing Service booth for more information about the latest study materials, classroom resources, professional development tools and training, and program management tools.

**HOUGHTON MIFFLIN HARCOURT

222 Berkeley Street
Boston, MA 02116
(251) 284-6665
Deanna Crosson, Account Executive
Deanna.crosson@hmc.com
Mark McMurray, Director, Business Development Adult Education
Mark.mcmurray@hmc.com

At Steck-Vaughn, now Houghton Mifflin Harcourt, we have a knack for preparing adult learners to harness opportunity and take charge of their future. Our Adult Education and Workforce Readiness solutions are designed to help learners attain basic academic skills, soft skills, and GED® test preparation in print and digital formats.

i-PATHWAYS CENTER FOR THE APPLICATION OF INFORMATION TECHNOLOGY AT WESTERN ILLINOIS UNIVERSITY

90 Horrabin Hall
Macomb, IL 61455
(309) 298-1804
Cindi Celske, i-Pathways Outreach Manager
ccelske@cait.org

i-Pathways is an online test preparation curriculum that prepares students for the 2014 GED® test. i-Pathways offers a mobile friendly learning management system with custom paths of learning per student, teaching tools, resources, technical support, and a variety of reporting options to ensure the success of your program's students.

INSTITUTE FOR THE PROFESSIONAL DEVELOPMENT OF ADULT EDUCATORS (IPDAE)

3209 Virginia Avenue
Fort Pierce, FL 34981
(772) 462-7409
June Rall
Jrall@irsc.edu

The Institute for the Professional Development of Adult Educators (IPDAE) is a state initiative supported by Florida Department of Education (FLDOE) and is housed at Indian River State College (IRSC). We offer research-based resources, technical assistance and professional development tools to assist programs as they continue to develop their Adult Education Career Pathways (AEC) system and align to the College and Career Readiness Standards (CCRS). IPDAE provides: a cutting-edge virtual resource center; strategic planning for program improvements; live and virtual learn opportunities; response to learning needs; preparation for the GED® assessment.

**MCGRAW-HILL CONTEMPORARY

8787 Orion Place
Columbus, OH 43240
(941) 356-7372
Kevin Curran, Sales Representative
Kevin.curran@mheducation.com

SPONSOR

McGraw-Hill/Contemporary delivers engaging, adaptive and personalized solutions that improve performance and results in ABE and high school equivalency degree programs. We combine proven, research-based content with the best emerging digital technologies to guide assessment, teaching and learning to achieve the best possible outcome for students, instructors and institutions.

MORGAN STANLEY

150 2nd Avenue North, Suite 1400
St. Petersburg, FL 33701
(727) 302-6329
Gina diGrandi, Financial Advisor Associate
Gina.digrandi@morganstanley.com
Fred Espro, Vice President, Portfolio Manager, Branch Manager
Fred.Espro@morganstanley.com

Once you retire, properly converting assets to income is just as important as accumulating them. When you take Social Security can have a big impact, and your retirement nest egg has to be carefully managed. Please join us at our booth for recent and soon-to-be retirees and learn how to generate income even after you have stopped earning it.

****Denotes Conference Sponsor**

NATIONAL GEOGRAPHIC LEARNING/ CENGAGE LEARNING

20 Channel Center Street
Boston, MA 02210
(561) 495-5018
Cindy Le, Post-Secondary ESL Specialist
Cindy.le@cengage.com

National Geographic Learning provides a portfolio of quality materials for PreK-12, academic, and adult education in the areas of ELA, ESL, reading and writing, science, social studies, and professional development. Combining print and media content in inspiring and innovative ways, the range of exciting series created by National Geographic Learning brings our world and its different cultures to life. From the classroom to the world – we honor the mission and tradition of the National Geographic Society – to inspire people to care about the planet.

NEW READERS PRESS

104 Marcellus Street
Syracuse, NY 13204
(850) 539-6285
Glenda Norvell, Sales
Norvell32333@bellsouth.net

New Readers Press, the publishing division of the nonprofit ProLiteracy, has affordable resources to meet the needs of your adult education students. Providing materials for GED®, Reading, ELL, Math, Workplace Skills and Teacher Resources, New Readers Press offers solutions for all of your adult education needs.

PEARSON ELT

10 Bank Street, 9th Floor
White Plains, NY 10606
(615) 478-1066
Ashley Murray, ELL Specialist
Ashley.p.murray@pearson.com
Michelle Velissariou, Sales Director
Michelle.velissariou@pearson.com
Julie Torguet, ELL Representative
Julie.torguet@pearson.com

Pearson ELT is the leading publisher of language programs for learners in English as a Second Language. In addition to its multilevel English courses, Pearson ELT publishes more than 30 separate dictionaries for customers in over 150 countries. Pearson Multimedia Programs provide interactive resources for teachers and learners of English.

PEARSON READINESS AND RETENTION

One Lake Street
Upper Saddle River, NJ 07458
(201) 236-5887
Cindy Hewitt, Executive Sales Specialist
Cindy.hewitt@pearson.com

Personalized solutions and services to help students prepare for credit bearing courses, excel at all levels, and succeed in their educational and career goals. Pearson Readiness & Retention solutions include award winning, online content and live, online tutoring that will positively impact student outcomes, persistence, and completion. www.pearsonhighered.com/college-readiness

QUIET ELEGANCE

1211 Carriage Lane
Orlando, FL 32807
(407) 380-5406
Michelle Clemons, Owner, Designer
quietelegance@gmail.com

We specialize in unique handcrafted jewelry. We also feature a line of affordable vibrant splashes of colorful fused glass necklaces. Stop by our booth for a refreshing shopping experience.

READING HORIZONS & EASY

2000 S. Ocean Drive, Suite 301
Ft. Lauderdale, FL 33316
(954) 462-7331
Caroline McNair, Distributor
caroline@anchorlearning.com
Claire Valier, Educational Consultant
Claire@anchorlearning.com

Anchor Learning provides literacy and ESL instruction with Reading Horizons and EASY, the ESL Series. EASY is a video-based comprehensive ESL curriculum. Reading Horizons provides effective, sequential instruction in decoding, spelling, and pronunciation strategies. Both programs offer foundational direct instruction and individualized software.

SILVER SUN

6500 N. Military, Unit 204
West Palm Beach, FL 33407
(617) 921-5599
Linda Quinn, Owner
LQL1533@yahoo.com

Silver-Sun has been in the jewelry business for over 28 years. We sell designer-style high end costume jewelry, the latest and newest styles, and designer style pocketbooks. I bring great pride in the latest high fashion jewelry and accessories. All of my products are nickel and lead free. Our manufacturers use only quality CZ's and the highest rhodium and gold plating. I am very proud to stand behind the quality of my products.

SPANISH FOR EVERYONE BOOKS AND CD'S

328 Eastwood Terrace
Boca Raton, FL 33431
(561) 716-7677
Susana Rios
rioszz@aol.com

Spanish for Everyone is a self published Spanish text book specially created and designed for Adult Education short courses in community schools. Excellent tool for educators to use as their text book to teach Spanish since it is self explanatory. It consists of 10 units and it gradually and clearly teaches students how to make their own sentences. Three books are available: Beginners, Intermediate and Workbook with Audio CDs included for pronunciation.

WONDERLIC

400 Lakeview Parkway, Suite 200
Vernon Hills, IL 60061
(847) 247-2539
Marlee Cittadino, Regional Account Executive
Marlee.cittadino@wonderlic.com

Wonderlic is the recognized leader in educational and pre-employment testing. The Wonderlic General Assessment of Instructional Needs (GAIN)® test measures basic English and math skills of adult learners. GAIN provides shorter testing time, motivational reports and targeted instructional suggestions. Wonderlic is an approved test publisher with the U.S. Department of Education and is recognized by all major accrediting associations.

****Denotes Conference Sponsor**

Thank You Conference Sponsors!



CTB



Gold Sponsor

CTB/McGraw-Hill

Stephanie Seemann

McGraw-Hill Contemporary

Kevin Curran

Tuesday's 'Power Up' Luncheon

Gold Sponsor

Houghton Mifflin Harcourt

Mark McMurray and Deanna Crosson

President's Reception and Dance

Silver Sponsor

GED Testing Service

Daphne Atkinson and Rafael Diaz

Grand Opening of Exhibits

Silver Sponsor

Burlington English

Zevi Aber, Lori Wedner, Robert Breitbard
and Claudia Llerandi

Conference Bags

Bronze Sponsor

Edgenuity

Heidi Griffith and Blythe Adreon

**Ice Cream Social
and Bingo with the Board**



TABE CLAS-E

CTB is a
Proud
GOLD Sponsor
of ACE

Help Your Adult Students Master Their Future with TABE Complete Language Assessment System—English™

Now Approved For Use by the Florida Department of Education

**Attend a presentation
on TABE CLAS-E;
see program for details.**



TABE CLAS-E™ offers teachers and administrators exactly what they need to quickly and accurately evaluate their adult students of English:

- Measures key skills of reading, listening, writing, and speaking
- Accurately places students prior to assessment with Locator Tests
- Seamlessly transitions into adult basic education programs
- Measures students' gains with pre-and post-testing
- Saves time with instructional guidance materials and immediate score reports

Contact your Florida specialist Stephanie Seemann
at 954.295.4212 or Stephanie_Seemann@ctb.com



ACE Website



**Follow us
on Twitter!**



**Follow us
on Facebook!**



Orlando Dining Options



ACE
of Florida

Adult and Community Educators of Florida, Inc.

www.aceofflorida.org

www.aceoffloridafoundation.org



912 S. Martin Luther King, Jr. Blvd
Tallahassee, FL 32301
850.222.2233 • www.aceofflorida.org

Funds for printing provided by Federal Adult Education and
Family Literacy Statewide Leadership grant project.

ACE of Florida, Inc. and ACE of Florida Foundation prohibits any policy or procedure which results in discrimination on the basis of age, color, disability, gender identity, gender expression, national origin, marital status, race, religion, sex, sexual orientation or genetic information. ACE of Florida, Inc. and ACE of Florida Foundation are equal opportunity employers.